

# STANLEY<sup>®</sup>

## FATMAX<sup>®</sup>

EN

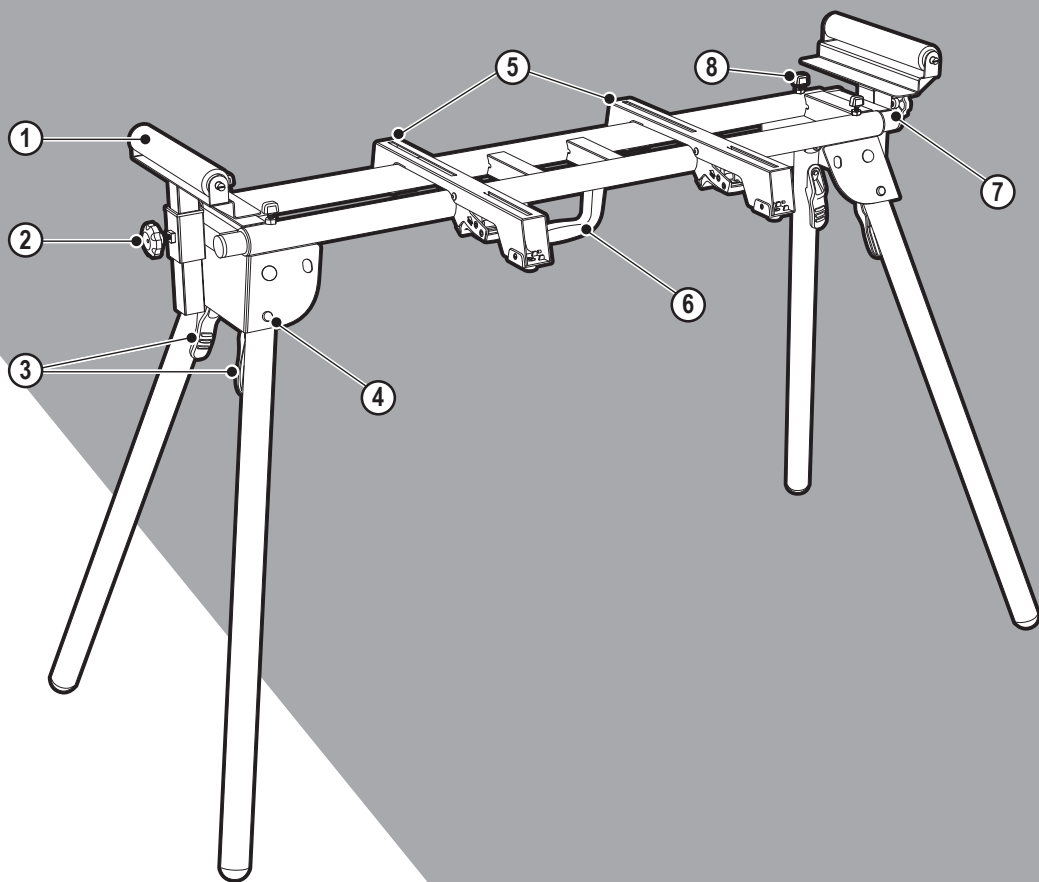

FME790

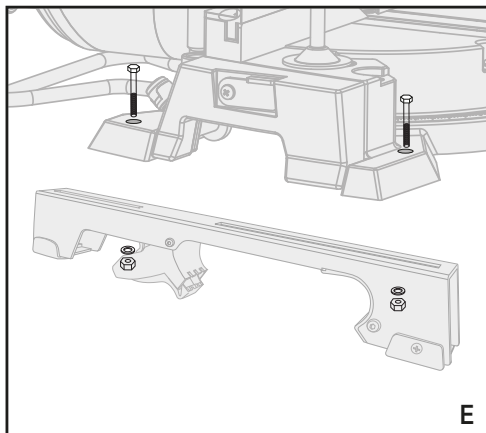
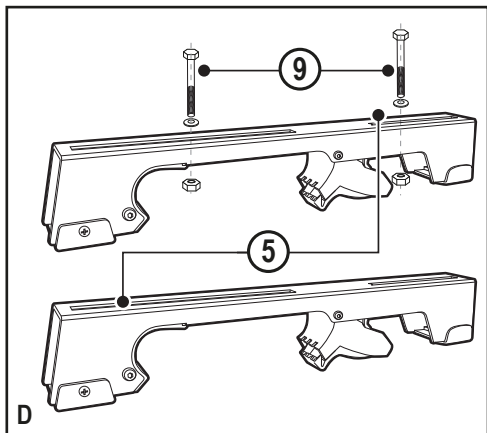
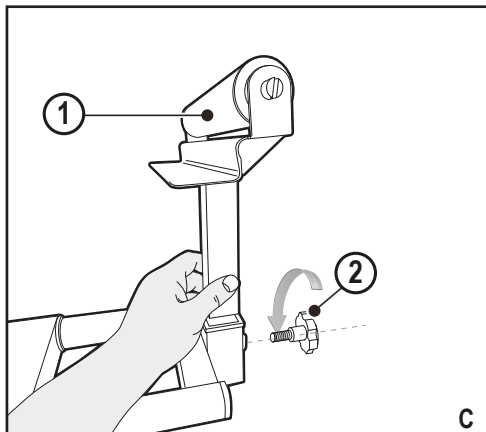
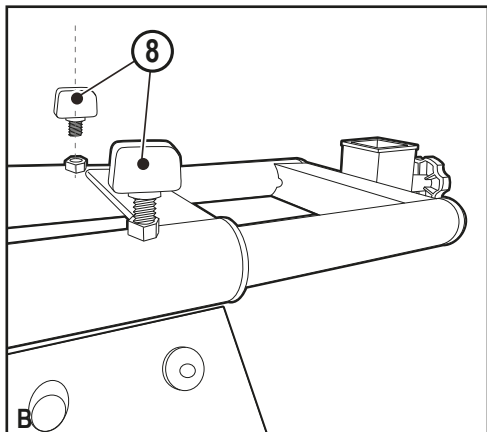
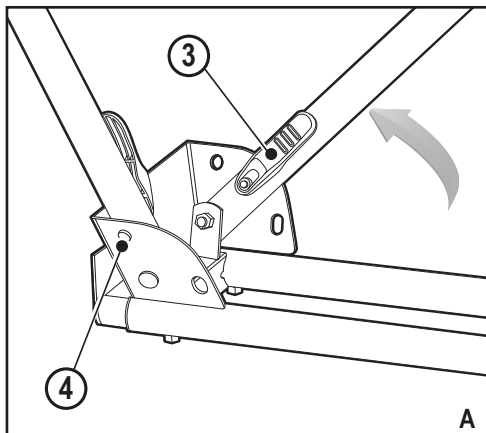
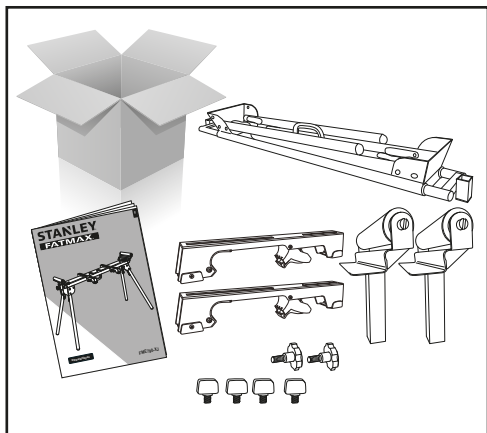

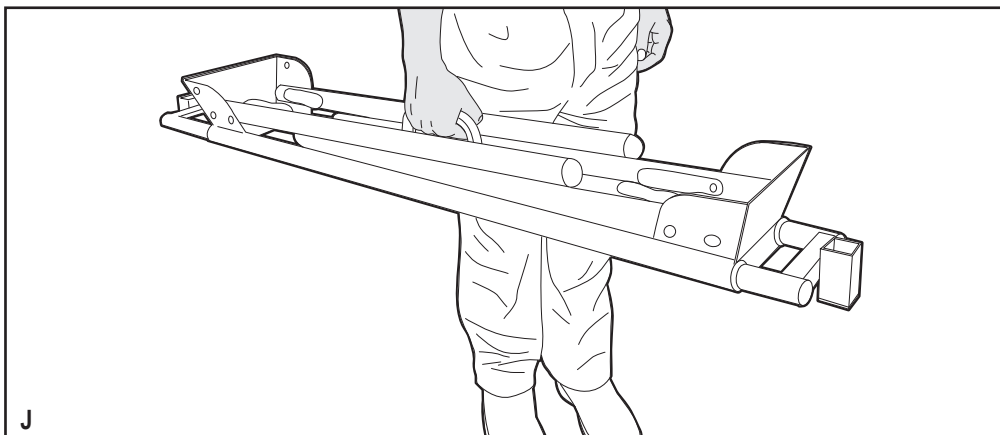
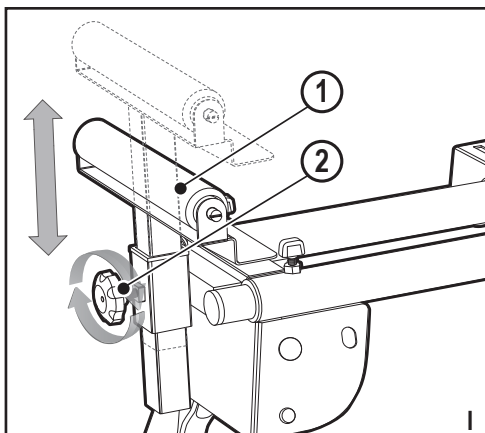
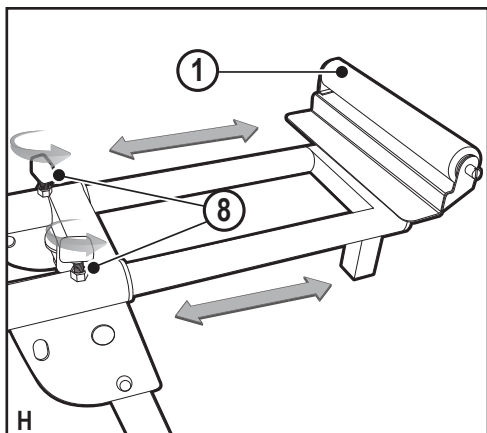
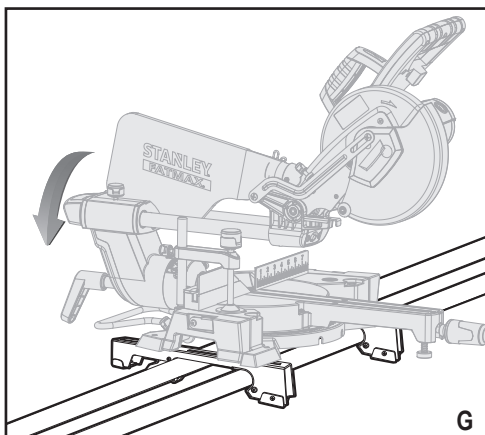
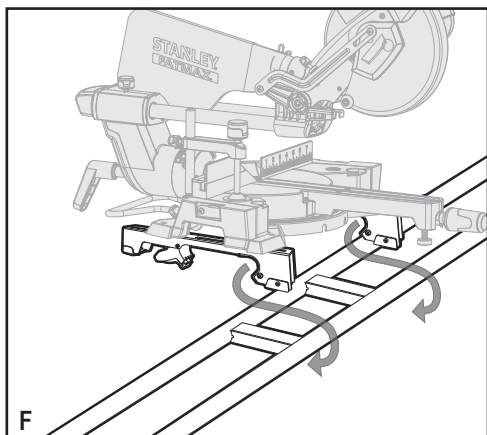

## Intended use

Your Stanley Fat Max FME790 mitre saw stand has been designed for use with a Stanley Fat Max mitre saws. This tool is intended for professional and private, non professional users.

## Safety instructions

### General safety warnings



**Warning!** Read all safety warnings and all instructions.

- ◆ Read all of this manual carefully before using the appliance.
- ◆ The intended use is described in this manual. The use of any accessory or attachment or the performance of any operation with this appliance other than those recommended in this instruction manual may present a risk of personal injury.
- ◆ Retain this manual for future reference.

### Using your appliance

Always take care when using the appliance.

- ◆ This appliance is not intended for use by persons (including children) with reduced physical, sensory or mental capabilities, or lack of experience and knowledge, unless they have been given supervision or instruction concerning use of the appliance by a person responsible for their safety. Children should be supervised to ensure that they do not play with the appliance.
- ◆ The appliance is not to be used as a toy.
- ◆ Use in a dry location only. do not allow the appliance to become wet.
- ◆ Do not immerse the appliance in water.
- ◆ Do not open body casing. There are no user serviceable parts inside.
- ◆ Do not operate the appliance in explosive atmospheres, such as in the presence of flammable liquids, gases or dust.

### After use

- ◆ When not in use, the appliance should be stored in a dry, well ventilated place out of the reach of children.
- ◆ Children should not have access to stored appliances.
- ◆ When the appliance is stored or transported in a vehicle it should be placed in the boot or restrained to prevent movement following sudden changes in speed or direction.

### Inspection and repairs

- ◆ Before use, check the appliance for damaged or defective parts.

Check for breakage of parts, damage to switches and any other conditions that may affect its operation.

- ◆ Do not use the appliance if any part is damaged or defective.
- ◆ Have any damaged or defective parts repaired or replaced by an authorised repair agent.
- ◆ Never attempt to remove or replace any parts other than those specified in this manual.
- ◆ In case of any missing parts, do not assemble the stand until the missing parts are obtained and are correctly installed.

### Additional safety instructions for mitre saw stand

- ◆ Fully assemble and tighten all the fasteners required for this stand. Also occasionally check the stand and make sure the mitre Saw is still tight. An unstable loose stand may shift in use and result in serious injury.
- ◆ Before operating, make sure the entire unit has been placed on a flat and solid level surface. If tool with stand is unstable and tips, serious injury may occur.
- ◆ Never STAND on tool or its stand or use them as a ladder or scaffolding. Serious injury could occur if the tool is tipped or the cutting tool is contacted accidentally. Do not store materials in a position on or near the tool where it necessary to stand on the tool or its stand to reach them.
- ◆ Use only our replacement parts. Any others may cause a hazard. The mitre saw should be mounted to the stand firmly according to the instruction manual. Properly align, position and balance the mitre saw according to the instruction manual after mounting the mitre saw to the stand.
- ◆ Never modify the stand in any manner or use the stand for any purpose other than is stated in the instructions.
- ◆ Cutting material may cause the stand to become unbalanced, always make sure the material is properly supported. If the piece being cut is placed far beyond the Work Support, the stand legs on the opposite side may be lifted up suddenly due to weight imbalance. Firmly Hold the opposite side before cutting to prevent this situation.

**Warning!** For your safety, never connect to power source until all assembly steps are complete and you have read and understood the entire owner's manual.

### Residual risks.

Additional residual risks may arise when using the tool which may not be included in the enclosed safety warnings. These risks can arise from misuse, prolonged use etc.

Even with the application of the relevant safety regulations and the implementation of safety devices, certain residual risks can not be avoided. These include:

- ◆ Injuries caused by touching any rotating/moving parts.

- ◆ Injuries caused when changing any parts, blades or accessories.
- ◆ Injuries caused by prolonged use of a tool. When using any tool for prolonged periods ensure you take regular breaks.
- ◆ Impairment of hearing.
- ◆ Health hazards caused by breathing dust developed when using your tool (example:- working with wood, especially oak, beech and MDF.)

## Features

This tool includes some or all of the following features.

1. Roller bracket
2. Roller bracket adjusting screw
3. Leg locking handle
4. Leg locking pin
5. Fixing arm
6. Carrying handle
7. Scalable bracket
8. Locking pin

## Use

### Preparing the stand (Fig. A)

- ◆ Lay down the stand's top surface on the floor with the folded legs on top.
- ◆ Push in a leg locking pin (4) and rotate that leg until the locking pin clicks into place.
- ◆ Repeat with the remaining three legs.
- ◆ Lift the stand.
- ◆ Check to ensure the stand is stable and all locking pins are in position.

### Assembling the roller brackets (Fig. B & C)

The roller brackets help balance the workpiece during cutting operations.

To assemble the roller brackets:

- ◆ Screw in the locking screws (8) through the locking screw holes at both ends of the stand, as shown in Figure B.
- ◆ Insert the roller brackets (1) into the square holes at both ends of the stand, Figure C.
- ◆ Place and tighten the adjustment screws (2) at both ends of the stand, Figure C.

### Attaching the mitre saw with supporting arms to stand (Fig. D, E, F & G)

#### Prepare supporting arms (Fig. D)

- ◆ Insert two M8x60 Bolts and washers (9) into each supporting arm.

**Warning!** Turn off tool switch and disconnect power before mounting to the stand. Unintended startup during assembly can cause injury.

To ensure balance and stability when using the saw, all four corners of the saw must be bolted to the mounting arms before use. Make sure bolts do not extend above the table of the mitre saw.

#### Attaching mitre saw to supporting arms (Fig. E)

The saw has four holes that line up with the slots in the supporting arms. See Figure E.

- ◆ Place the supporting arms downward.
- ◆ Lift one side of the saw and place a supporting arm underneath, aligning the socket head cylinder cap screws with mitre saw mounting holes, as shown in figure E.
- ◆ Seat the mitre saw onto the supporting arm, feeding the socket head cylinder cap screws through each mounting hole.
- ◆ Use a plain washer and nut (10) to hold in position.
- ◆ Repeat the above 4 steps to install second bracket to the other side of the saw.
- ◆ Make sure the brackets are parallel to each other. Use a tool adjustable wrench to tighten each nut.

#### Attaching the mitre saw and bracket assembly to stand (Fig. F & G)

- ◆ Lift the saw and bracket assembly, allowing the assembly to tilt slightly toward your body.
- ◆ When the bracket assembly is tilted toward you, hook its front edge onto the front rail of the stand, see Figure F.

**Warning!** To avoid serious injury, before seating the rear end of the bracket, make sure the curved front edge of the mounting bracket are securely seated over the front rail. Failure to do so could cause you to lose control of the saw mounting assembly.

- ◆ Lower the bracket assembly, allowing its rear edge to fully seat over the rear rail, Figure G.

**Note:** Use one hand to hold the mounting bracket assembly until both levers are securely locked.

- ◆ Check position and adjust if necessary, to make sure the weight of the saw is evenly balanced over the rails as shown in Figure G.
- ◆ Ensure the saw is fully seated and locked in position, then tighten the four nuts to hold the saw to the mounting bracket.

#### Removing saw from stand

- ◆ Loosen the locking arms to unlock the saw and mounting bracket assembly.
- ◆ Lift the saw away from the rear rail of the stand to disengage.

- ◆ Slightly tilt the assembly toward you, lift the front part of the assembly to disengage from the front rail of the stand, see Figure F.

### The stand compatibility test

With the saw mounted on the stand:

- ◆ Check for fit and function. There shall be no interference of mitre saw throughout the full range of mitre, bevel and compound cut.
- ◆ The Work Support can be adjusted to a height that is level with the table top of the mitre saw.

### Using the scalable bracket (Fig. H & I)

- ◆ Use the scalable bracket when working with large work pieces.

### Extending the rails

- ◆ Loosen the locking screw (8).
- ◆ Extend the scalable bracket to the desired position.
- ◆ Tighten the locking screw.
- ◆ When the scalable bracket has been extended to the warning position, it should not be further extended.

### Adjusting height of the roller brackets

- ◆ Loosen the roller bracket adjustment screw at the end of the scalable bracket, as shown in Figure I. Lift the roller bracket to a height that is level with the table top of the mitre saw.
- ◆ Retighten knob and repeat on the opposite side.

**Warning:** To reduce the risk of injury, make sure the roller brackets are adjusted so that the workpiece sits flat on the mitre saw table. Workpieces that do not sit flat could cause the blade to bind during cutting.

### Carry Handle (Fig. J)

A handle (6) has been supplied to transport the mitre saw stand to and from the work site.

**WARNING:** To reduce the risk of personal injury, DO NOT attempt to store the stand with the saw attached. Loss of control may result.

### Maintenance

**Warning:** To reduce the risk of injury, periodically ensure all fasteners are attached and adjusted according to the assembly instructions in this manual.

**Warning:** When servicing, use only our identical replacement parts. The use of any other parts may cause a hazard or result in product damage.

**Warning:** Avoid using solvents when cleaning plastic parts. Most plastics are susceptible to damage from commercial solvents and may be damaged by use of solvents. Use clean cloths to remove dirt, dust, oil, grease, etc.

### Technical Data

FME790		
Length	mm	1120
Length with bars extended	mm	2148
Height	mm	994
Maximum working load	kg	185
Weight	kg	14.3

### Protecting the environment



Separate collection. This product must not be disposed of with normal household waste.

Should you find one day that your Stanley product needs replacement, or if it is of no further use to you, do not dispose of it with household waste. Make this product available for separate collection.



Separate collection of used products and packaging allows materials to be recycled and used again. Re-use of recycled materials helps prevent environmental pollution and reduces the demand for raw materials.

Local regulations may provide for separate collection of electrical products from the household, at municipal waste sites or by the retailer when you purchase a new product.

Stanley Fat Max provides a facility for the collection and recycling of Stanley Fat Max products once they have reached the end of their working life. To take advantage of this service please return your product to any authorised repair agent who will collect them on our behalf.

You can check the location of your nearest authorised repair agent by contacting your local Stanley Fat Max office at the address indicated in this manual. Alternatively, a list of authorised Stanley Fat Max repair agents and full details of our after-sales service and contacts are available on the Internet at: [www.2helpU.com](http://www.2helpU.com)



**Australia & New Zealand**

Stanley Black & Decker

82 Taryn Drive, Epping, VIC 3076 Australia

Tel. 1800 338 002 (Aust) or Tel. 0800 339 258 (NZ)