

STANLEY[®]

FATMAX[®]

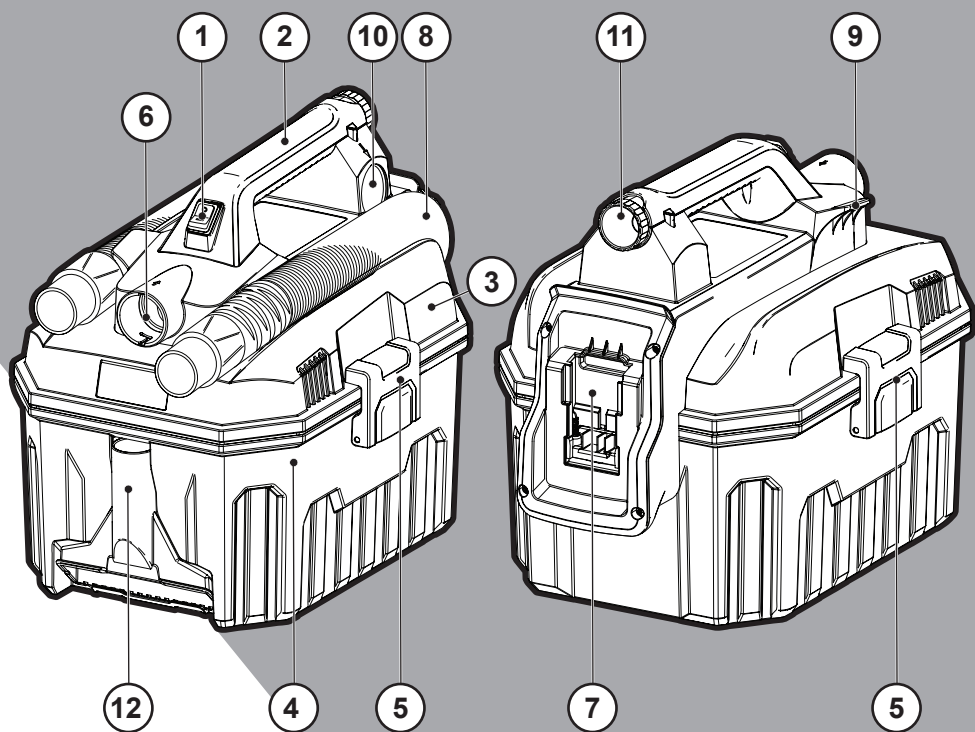

FMC795B

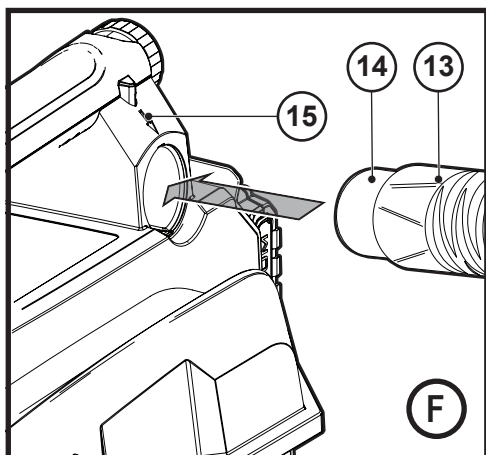
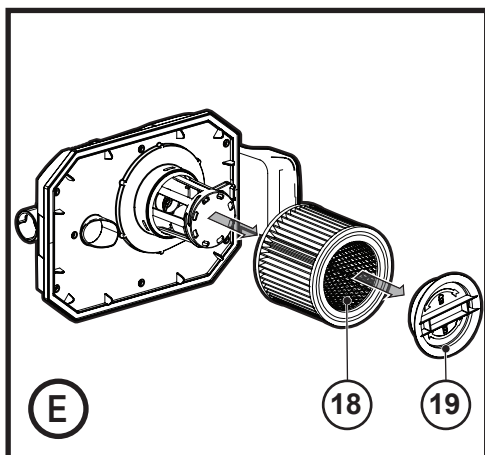
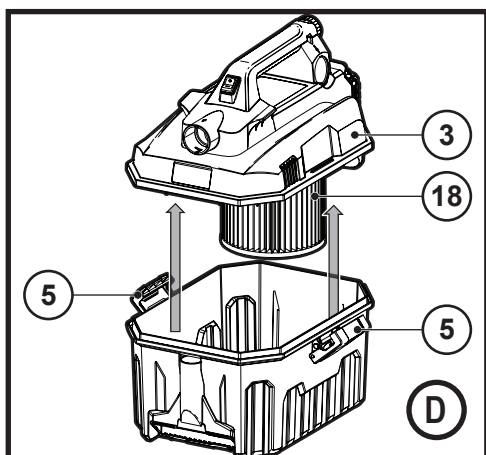
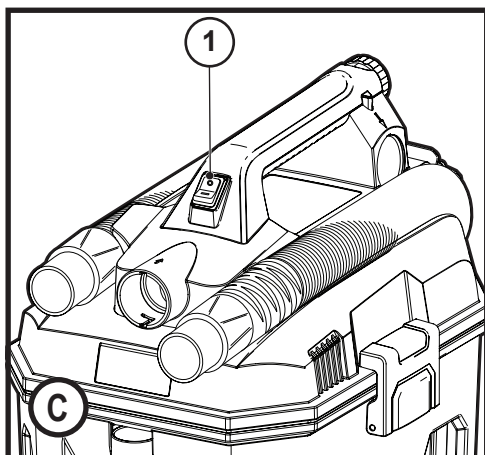
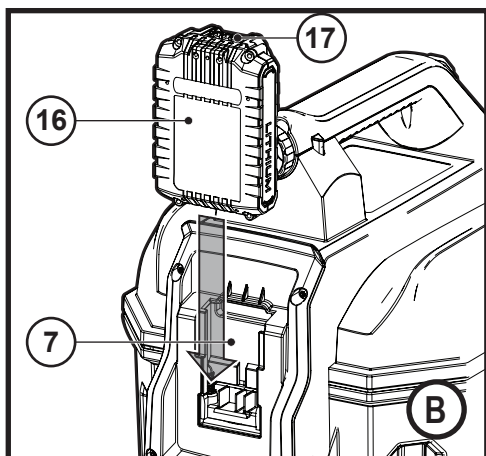
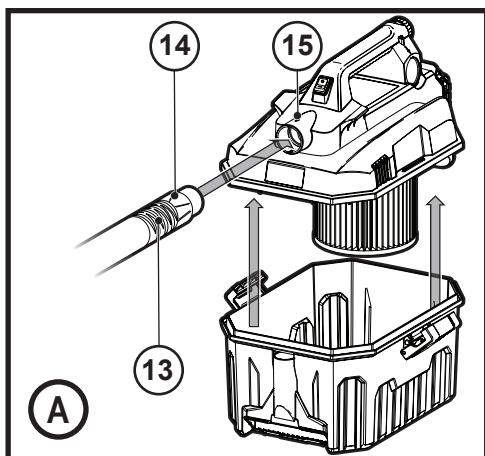

Intended use

Your Stanley Fat Max FMC795B wet & dry vac has been designed for wet and dry vacuum cleaning purposes. This appliance is intended for professional and private, non professional users.



Read all of this manual carefully before operating the appliance.

Safety instructions



Warning! Read all safety warnings and all instructions.

Failure to follow the warnings and instructions listed below may result in electric shock, fire and/or serious injury.

- ♦ The intended use is described in this manual. The use of any accessory or attachment or the performance of any operation with this appliance other than those recommended in this instruction manual may present a risk of personal injury.
- ♦ Retain this manual for future reference.

Using your appliance

- ♦ Do not use the appliance to pick up liquids or any materials that could catch fire
- ♦ Do not immerse the appliance in water.
- ♦ Never pull the charger lead to disconnect the charger from the socket. Keep the charger lead away from heat, oil and sharp edges.

Safety of others

- ♦ This tool is not intended for use by persons (including children) with reduced physical, sensory or mental capabilities, or lack of experience and knowledge, unless they have been given supervision or instruction concerning use of the tool by a person responsible for their safety.
- ♦ Children should be supervised to ensure that they do not play with the appliance.

Inspection and repairs

Before use, check the appliance for damaged or defective parts.

Check for breakage of parts, damage to switches and any other conditions that may affect its operation.

- ♦ Do not use the appliance if any part is damaged or defective.
- ♦ Have any damaged or defective parts repaired or replaced by an authorized repair agent.
- ♦ Regularly check the charger lead for damage. Replace the charger if the lead is damaged or defective.
- ♦ Never attempt to remove or replace any parts other than those specified in this manual.

Additional safety instructions

After use

- ♦ Unplug the charger before cleaning.
- ♦ When not in use, the appliance should be stored in a dry place.

- ♦ Children should not have access to stored appliances.

Residual risks

Additional residual risks may arise when using the tool which may not be included in the enclosed safety warnings. These risks can arise from misuse, prolonged use etc.

Even with the application of the relevant safety regulations and the implementation of safety devices, certain residual risks can not be avoided. These include:

- ♦ Injuries caused by touching any rotating/moving parts.
- ♦ Injuries caused when changing any parts, blades or accessories.
- ♦ Injuries caused by prolonged use of a tool. When using any tool for prolonged periods ensure you take regular breaks.
- ♦ Impairment of hearing.
- ♦ Health hazards caused by breathing dust developed when using your tool (example:- working with wood, especially oak, beech and MDF.)

Batteries (not supplied)

- ♦ Never attempt to open for any reason.
- ♦ Do not expose the battery to water.
- ♦ Do not store in locations where the temperature may exceed 40 °C.
- ♦ Charge only at ambient temperatures between 10 °C and 40 °C.
- ♦ Charge only using the charger provided with the tool.
- ♦ If the appliance is to be stored unused for a long period, the batteries should be removed.

- ♦ When disposing of batteries, follow the instructions given in the section "Protecting the environment".



Do not attempt to charge damaged batteries.

Chargers (not supplied)

- ♦ Use your Stanley Fat Max charger only to charge the battery in the tool with which it was supplied. Other batteries could burst, causing personal injury and damage.
- ♦ Never attempt to charge non-rechargeable batteries.
- ♦ Have defective cords replaced immediately.
- ♦ Do not expose the charger to water.
- ♦ Do not open the charger.
- ♦ Do not probe the charger.

Electrical safety

Symbols on the charger



Read all of this manual carefully before using the appliance.



The charger is intended for indoor use only.

Features

This tool includes some or all of the following features.

1. On/off power switch
2. Main handle
3. Power head
4. Tank
5. Tank latch
6. Intake port
7. Battery port
8. Vacuum hose
9. Hose clip
10. Side exhaust port
11. Crevice tool
12. Wide nozzle tool

Assembly

Attaching vacuum hose (Fig. A)

The vacuum hose (8) will need to be attached to the vacuum before using the appliance.

- ◆ Place the vacuum on a flat, firm surface
- ◆ Unlatch tank latches (5) and remove power head from the tank. Remove the hose (8) from the tank.
- ◆ Align the hose end (13) with the intake port (6) on the front of the appliance, ensuring the hose alignment lock (14) is aligned with the arrow (15) on the intake port.
- ◆ Insert the hose end into the intake port and twist clockwise to lock in place.
- ◆ Replace power head onto the tank and secure latches.

Note: The power head will only fit onto the tank when the intake port on the front of the power head and the storage area for the wide nozzle tool on the tank are aligned as shown in figure A.

Charging the battery (not supplied)

The battery needs to be charged before first use and whenever it fails to produce sufficient power on jobs that were easily done before. The battery may become warm while charging; this is normal and does not indicate a problem.

Warning! Do not charge the battery at ambient temperatures below 10 °C or above 40 °C. Recommended charging temperature: approx. 24 °C.

Note: The charger will not charge a battery if the cell temperature is below approximately 10 °C or above 40 °C.

The battery should be left in the charger and the charger will begin to charge automatically when the cell temperature warms up or cools down.

- ◆ To charge the battery (16), insert it into the charger. The battery will only fit into the charger in one way. Do not force. Be sure that the battery is fully seated in the charger.
- ◆ Plug in the charger and switch on at the mains.

The charging indicator will flash continuously (slowly). The charge is complete when the charging indicator lights continuously. The charger and the battery can be left connected indefinitely with the LED illuminated. The LED will change to flashing (charging) state as the charger occasionally tops up the battery charge.

The charging indicator will be lit as long as the battery is connected to the plugged-in charger.

- ◆ Charge discharged batteries within 1 week. Battery life will be greatly diminished if stored in a discharged state.

Leaving the battery in the charger

The charger and battery pack can be left connected with the LED glowing indefinitely. The charger will keep the battery pack fresh and fully charged.

Charger diagnostics

If the charger detects a weak or damaged battery, the charging indicator will flash red at a fast rate. Proceed as follows

- ◆ Re-insert the battery (16).
- ◆ If the charging indicators continue flashing at a fast rate, use a different battery to determine if the charging process works properly.
- ◆ If the replaced battery charges correctly, the original battery is defective and should be returned to a service centre for recycling.
- ◆ If the new battery gives the same indication as the original battery, take the charger to be tested at an authorised service centre.

Note: It may take as long as 60 minutes to determine that the battery is defective. If the battery is too hot or too cold, the LED will alternately blink, fast and slow, one flash at each speed and repeat.

Installing and removing the battery pack (not supplied) (Fig. B)

Warning! Ensure battery port and terminals are dry and clean before installing battery pack.

- ◆ To install the battery pack (16) into the power head, align the battery pack with the rails inside the tool's battery port (7) until the battery pack is firmly seated in the tool and ensure that it does not disengage.
- ◆ To remove the battery pack from the tool, press the release button (17) and firmly pull the battery pack out of the tool handle. Insert it into the charger as described in the charger section of this manual.

Correct hand position

Warning! To reduce the risk of serious personal injury, **ALWAYS** hold securely in anticipation of a sudden reaction.

- ◆ Proper hand position requires one hand on the main handle (2).

Use

On / Off Switch (Fig. C)

- ◆ Attach the appropriate accessory to the hose (8).
- ◆ Insert battery pack.
- ◆ To turn vacuum on, press the I/O (on/off) button (1).

Dry vacuum cleaning

To empty tank (FIG. D)

The sound of the motor changes and suction is reduced when the tank is full.

- ◆ Turn vacuum off. Remove the battery pack.

- ◆ Unlatch tank latches (5) and remove power head from the tank.
- ◆ Empty contents of tank into suitable container.
- ◆ Clean or change filter (18). See Filter section of this manual.
- ◆ Inspect vacuum for damage by foreign objects. Contact the nearest Stanley Fat Max authorized service center for replacement of damaged or missing parts.
- ◆ Replace power head (3) onto the tank (4) and latch securely.

Dry vacuum cleaning

Warning! Do not tilt vacuum when in use.

If vacuum has liquid in the tank it may spill out from the exhaust port.

Warning! Ensure battery port and terminals are dry and clean before installing battery pack.

The filter must be removed before using the vacuum to clean liquids. See Filter section of this manual.

To empty tank

The sound of the motor changes and suction is reduced when the tank is full.

- ◆ Turn vacuum off. Remove the battery pack.
- ◆ Unlatch tank latches (5) and remove power head from the tank.
- ◆ Empty contents of tank.
- ◆ Inspect vacuum for damage by foreign objects. Contact the nearest Stanley Fat Max authorized service center for replacement of damaged or missing parts.
- ◆ Dry inside of power head and tank with a clean cloth.
- ◆ Replace power head (3) onto the tank (4) and latch securely.

Filter

Filter care

The wet/dry filter (18) included with this vacuum is a long life filter. To be effective in minimizing dust recirculation the filters **MUST** be installed correctly and in good condition.

Note: A clean filter is the most important factor in the operation and efficiency of any vacuum. If the filter becomes clogged beyond cleaning, damaged, or fails to operate properly, replace only with a recommended replacement.

To clean or change the filter (Fig. E)

- ◆ Turn vacuum off. Remove the battery pack.
- ◆ Unlatch the tank latches (5) and remove the power head from the tank as shown in figure D. Unlock the filter lock (19) by twisting it counter clockwise. Pull the filter (18) out to remove it from the power head
- ◆ Clean the filter by shaking off excess dust, tapping into a waste receptacle, then rinsing under running water.

Depending on the condition of the filter, a water wash is not always required. Do not use a brush to clean filter.

- ◆ Reinstall filter and secure the filter lock onto power head. Twist the filter lock clockwise and ensure the filter is locked in place.
- ◆ Replace power head onto the tank and secure latches.

Note: Please contact your local service center or visit our website www.stanley.eu/3 to purchase a filter.

Blower

The blower function can be used to remove debris from behind small spaces, to dry a damp floor, to blow grass clippings or leaves from an outside walk, patio, etc.

To use as a blower (Fig. F)

- ◆ Empty the tank following the instructions under the Vacuum Cleaning section of this manual.
- ◆ Twist the vacuum hose (2) counter clockwise to remove from the intake port.
- ◆ Align the hose end (13) with the side exhaust port (10), ensuring the hose alignment lock 14 is aligned with the arrow 15 above the side exhaust port.
- ◆ Insert the hose end into the side exhaust port and twist clockwise to lock in place.

Hose and accessory storage

When the vacuum is not in use, remove the battery pack.

The vacuum hose can be wrapped around appliance, underneath the battery interface, and secured with the hose clip (7) also located at the back of the vacuum. The two accessories (crevice tool and wide nozzle) can be stored on board the vacuum as well.

Troubleshooting guide

Problem	Possible cause	Possible Solution
Unit will not start	Battery pack not installed properly. Battery pack not charged. Internal components too hot. Brushes worn out.	Check battery pack installation Check battery pack charging requirements. Allow tool to cool down. Have motor replaced by an authorized Stanley Fat Max service center Have brushes replaced by an authorized Stanley Fat Max service center

Battery pack will not charge.	Battery pack not inserted into charger. Charger not plugged in. Surrounding air temperature too hot or too cold.	Insert battery pack into charger until LED illuminates. Plug charger into a working outlet. Refer to "Important charging notes" for more details. Move charger and battery pack to a surrounding air temperature below 10 °C or above 40 °C.
Unit shuts off abruptly.	Battery pack has reached its maximum thermal limit. Out of charge. (To maximize the life of the battery pack it is designed to shut off abruptly when the charge is depleted.)	Allow battery pack to cool down. Place on charger and allow to charge.
Unit has reduced suction.	Tank is full. Filter is dirty or clogged.	Empty tank. Clean or replace filter.

Technical Data

	FMC795B
Voltage	18V
Weight	3.32Kg

Charger		905998**typ.1	906086**typ.1
Input voltage	V _{AC}	230	230
Output Voltage	V _{CC}	18	18
Current	A	1	2
Approx. charge time	min	90 - 240	45 - 120

Battery		FMC689L	FMC687L	FMC688L
Voltage	V _{CC}	18	18	18
Capacity	Ah	1.5	2.0	4.0
Type		Li-ion	Li-ion	Li-ion

Maintenance

Your Stanley Fat Max cordless appliance has been designed to operate over a long period of time with a minimum of maintenance. Continuous satisfactory operation depends upon proper tool care and regular cleaning.

Warning! Before performing any maintenance on cordless appliances:

- ◆ Run the battery down completely if it is integral and then switch off.
- ◆ Unplug the charger before cleaning it. Your charger does not require any maintenance apart from regular cleaning.
- ◆ Regularly clean the ventilation slots in your appliance/charger using a soft brush or dry cloth.
- ◆ Regularly clean the motor housing using a damp cloth. Do not use any abrasive or solvent-based cleaner.

Replacing the filters

The filters should be replaced every 6 to 9 months and whenever worn or damaged. Replacement filters are available from your Stanley Fat Max dealer. Please visit our website www.stanley.eu/3

- ◆ Remove the old filters as described above
- ◆ Fit the new filters as described above

Protecting the environment



Separate collection. Products and batteries marked with this symbol must not be disposed of with normal household waste.

Products and batteries contain materials that can be recovered or recycled reducing the demand for raw materials. Please recycle electrical products and batteries according to local provisions. Further information is available at www.2helpU.com

Australia & New Zealand

Stanley Black & Decker

www.blackanddecker.com.au

www.blackanddecker.co.nz

Tel.1800 338 002 (Aust) or Tel. 0800 339 258 (NZ)

