



ASSEMBLY INSTRUCTIONS

To simplify the assembly process, finger tighten all bolts until all bolts are in place. Once all bolts are in place, you can then final tighten.

1. Carefully lay bottom tray of utility cart on a clean work surface.
2. Take four legs with bumpers and bolt them to the bottom tray using the Torx bolts (A). Legs are labeled BL(back left), BR(back right), FL(front left) and FR(front right).
3. If you do not have an add-on drawer unit (MB89UCAD33, MB89UCAD36, or MB89UCAD6) proceed with bolting top tray in place and finger tighten all bolts. Remove the tie straps from legs and bumpers. Attach torx bolts to center holes of legs using spring washers, flat washers, and nuts.

If you have an add-on drawer unit (MB89UCAD33, MB89UCAD36, or MB89UCAD6), do not install the top front bolt on the FL and FR legs. Leave the side bolts on the FL and FR legs loose. Remove the tie straps from legs and bumpers. The next step is mount the prybar holders which are labeled left and right. Mount the left prybar holder to the inside of the left legs using the holes near the center of the legs. Mount the right prybar holder to the inside of the right legs using the holes near the center of the legs. Secure using Torx bolts, flat washers, spring washers, and hex nuts; this hardware comes with the drawer unit along with a separate assembly sheet. Remove the keys from the drawer unit. The drawer unit will now slide in the front of the cart and rest on the prybar holders. Align holes in top of drawer unit with holes in top tray and secure using hex bolts and flat washers. Secure the bottom of the drawer unit to the prybar holders using hex bolts and flat washers. Now tighten side bolts and front bolts of the legs.

4. Determine which side the cart handle will be on. Remove the lower side bolts from the front and back legs. Mount handle and tighten bolts. You can now final tighten all bolts.

WARNING: Make sure the lid is locked.

5. Using handle, roll cart forward onto the opposite side. Mount casters using hex bolts, spring washers, and flat washers.

NOTE: It is recommended that the locking casters go onto the same side as the handle.

6. Roll cart upright onto casters.
7. Install divider in bottom tray if desired.



MB89UCL, -BK, -BL, -YE, -LG, -OR, -PP, -GRAY Utility Cart w/ Locking Lid

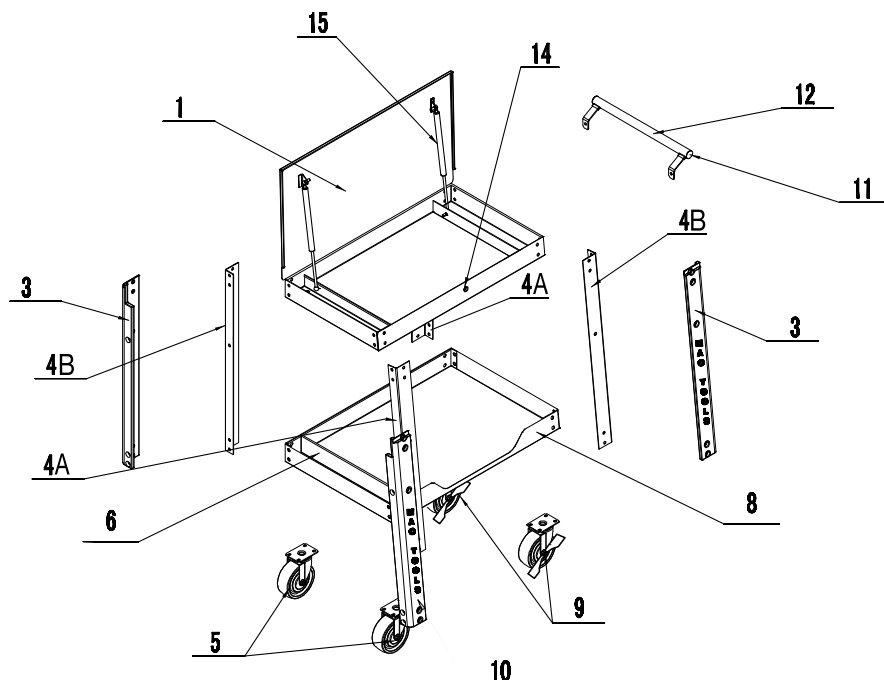

PARTS LIST

Item No.	Part No.	Description	Qty
1	MB89UCLLID	Red Top Tray w/ Locking Lid	1
	MB89UCLLIDBK	Black Top Tray w/ Locking Lid	
	MB89UCLLIDBL	Blue Top Tray w/ Locking Lid	
	MB89UCLLIDYE	Yellow Top Tray w/ Locking Lid	
	MB89UCLLIDLG	Lime Green Top Tray w/ Locking Lid	
	MB89UCLLIDOR	Orange Top Tray w/ Locking Lid	
	MB89UCLLIDPP	Purple Top Tray w/ Locking Lid	
	MB89UCLLIDGRAY	Gray Top Tray w/ Locking Lid	
3	RS89UCLB	Leg Bumpers (set of 4)	1
4A	RS89UCLGA	Red Leg/each for front left or back right	2
	RS89UCLGABK	Black Leg/each for front left or back right	
	RS89UCLGABL	Blue Leg/each for front left or back right	
	RS89UCLGAYE	Yellow Leg/each for front left or back right	
	RS89UCLGALG	Lime Green Leg/each for front left or back right	
	RS89UCLGAOR	Orange Leg/each for front left or back right	
	RS89UCLGAPP	Purple Leg/each for front left or back right	
	RS89UCLGAGRAY	Gray Leg/each for front left or back right	
4B	RS89UCLGB	Red Leg/each for front right or back left	2
	RS89UCLGBBK	Black Leg/each for front right or back left	
	RS89UCLGBBL	Blue Leg/each for front right or back left	
	RS89UCLGBYE	Yellow Leg/each for front right or back left	
	RS89UCLGBLG	Lime Green Leg/each for front right or back left	
	RS89UCLGBOR	Orange Leg/each for front right or back left	

Item No.	Part No.	Description	Qty
	RS89UCLGBPP	Purple Leg/each for front right or back left	
	RS89UCLGBGRAY	Gray Leg/each for front right or back left	
5	RS89UCNLC	Non-Locking Caster/each	2
6	RS89SCD	SprayCan Divider-Red	1
	RS89SCDBK	SprayCan Divider-Black	
	RS89SCDBL	SprayCan Divider-Blue	
	RS89SCDYE	SprayCan Divider-Yellow	
	RS89SCDLG	SprayCan Divider-Lime Green	
	RS89SCDOR	SprayCan Divider-Orange	
	RS89SCDPP	SprayCan Divider-Purple	
	RS89SCDGRAY	SprayCan Divider-Gray	
8	MB89UCBS	Bottom Tray-Red	1
	MB89UCBSBK	Bottom Tray-Black	
	MB89UCBSBL	Bottom Tray-Blue	
	MB89UCBSYE	Bottom Tray-Yellow	
	MB89UCBSLG	Bottom Tray-Lime Green	
	MB89UCBSOR	Bottom Tray-Orange	
	MB89UCBSPP	Bottom Tray-Purple	
	MB89UCBSGRAY	Bottom Tray-Gray	
9	RS89UCLC	Locking Caster/each	2
12	RS89UCPH	Push Handle	1
14	RS89LK	Chrome Lock w/keys	1
	RS89LKBK	Black Lock w/ keys	
15	RS89UCLGP	Gas Piston/each	2

HARDWARE SPECIFICATIONS

A	Torx Bolts (M8 x 18)	40 Pcs.
B	Hex Bolts (M8 x 16)	16 Pcs.
C	Flat Washers	24 Pcs.
D	Spring Washers	24 Pcs.
E	Nut	8 Pcs.

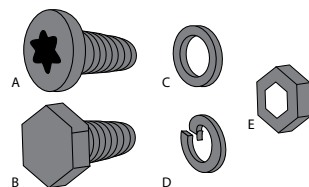

Available as:

RS195UCBK	32 Torx Bolts (M8 x 18)
RS89UCCB	Caster Bolt Kit (16 each of B, C, & D)
RS89LBK	Leg Bolt Kit (8 each of Torx Bolts [M8 x 18], Flat Washers, Spring Washers, Nuts)

Replacement liners available as RS89UCLK, liner set for Top and Bottom Trays

Replacement MAC TOOLS logo decal available as RS89MACLOGO (white) or as RS89MACLOGOBK (black)