

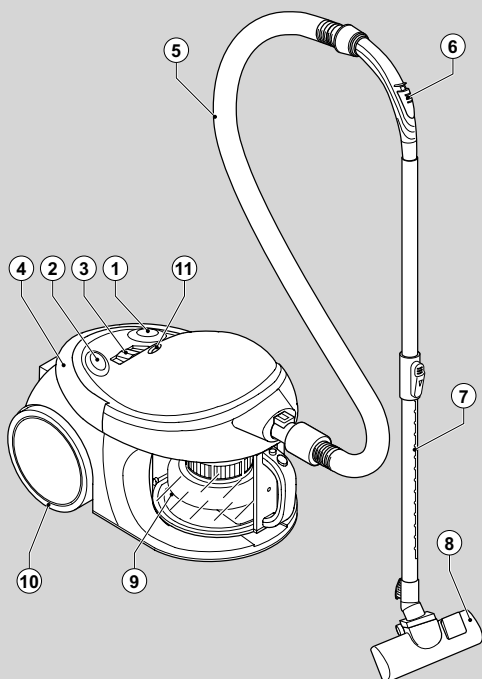

BLACK & DECKER®

www.blackanddecker.co.uk



UK

Ireland

Australia

New Zealand

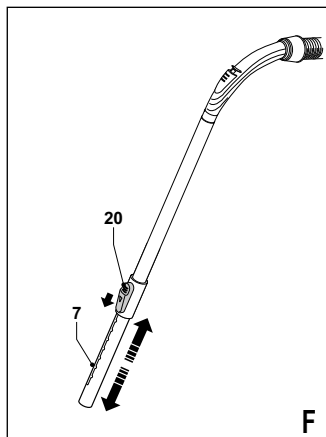
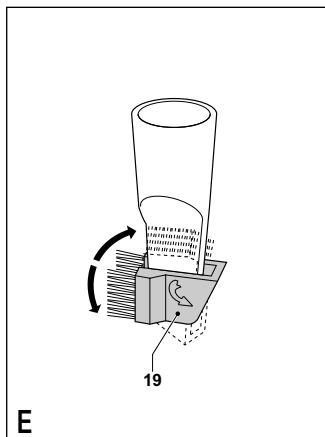
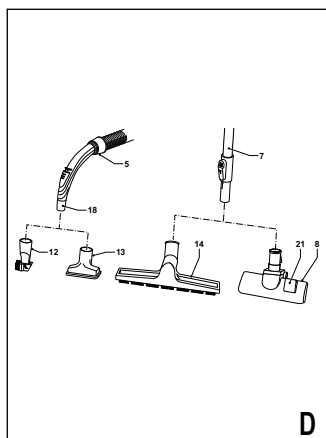
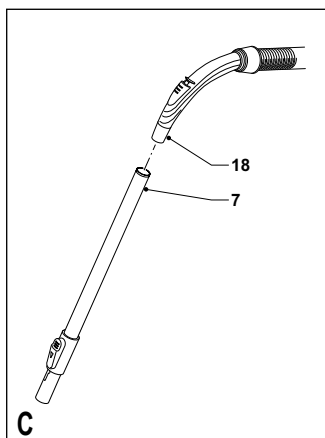
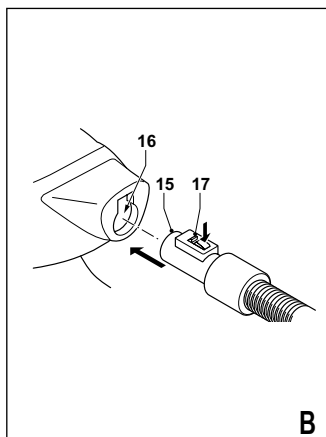
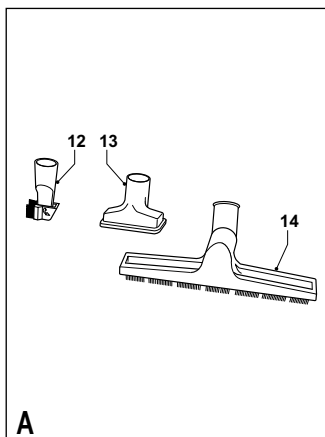

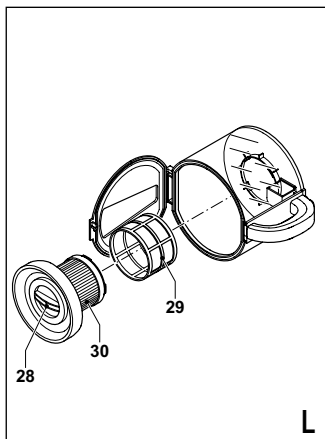
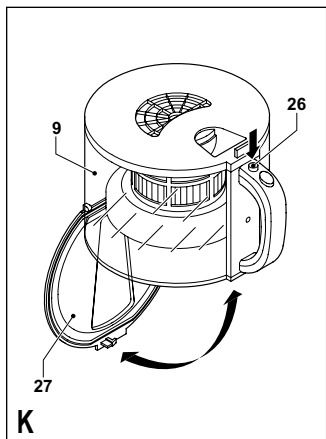
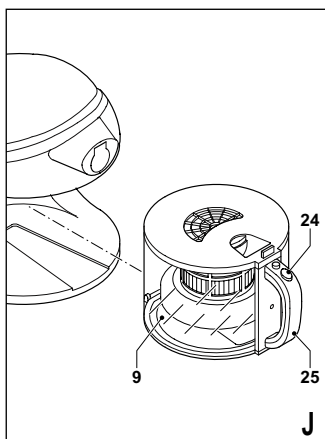
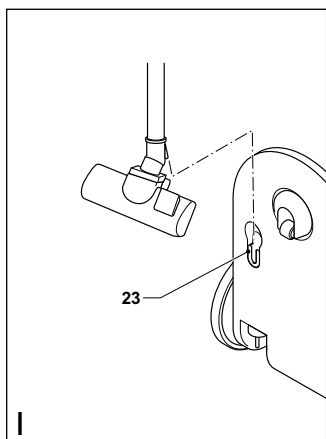
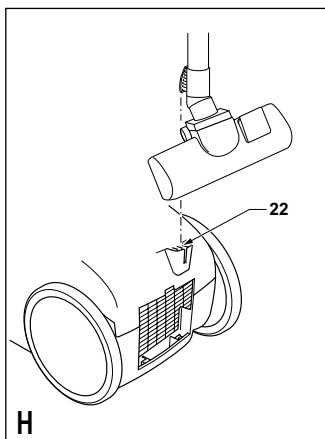
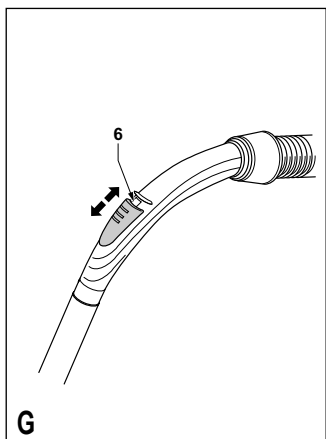

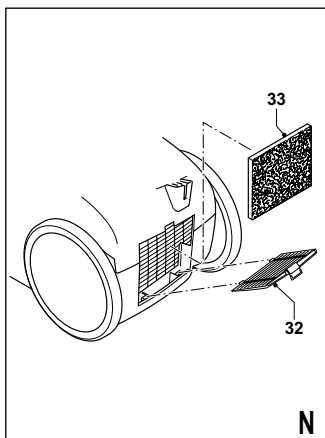
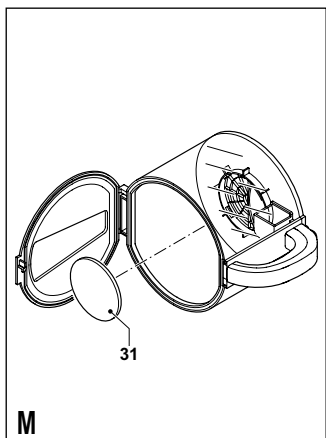

Intended use

Your Black & Decker vacuum cleaner has been designed to vacuum dry substances. This product is intended for household use only.

Safety instructions

- ◆ **Warning!** When using mains-powered appliances, basic safety precautions, including the following, should always be followed to reduce the risk of fire, electric shock, personal injury and material damage.
- ◆ Read all of this manual carefully before using the appliance.
- ◆ The intended use is described in this manual. The use of any accessory or attachment or the performance of any operation with this appliance other than those recommended in this instruction manual may present a risk of personal injury.
- ◆ Retain this manual for future reference.

Using your appliance

- ◆ Make sure that the appliance is switched off before connecting to or disconnecting from the power supply.
- ◆ Always take care when using the appliance.
- ◆ Do not use the appliance outdoors.
- ◆ Never pull the power supply cord to disconnect the plug from the socket. Keep the power supply cord away from heat, oil and sharp edges.
- ◆ If the power supply cord is damaged during use, disconnect the appliance from the power supply immediately. Do not touch the power supply cord before disconnecting from the power supply.
- ◆ Disconnect the appliance from the power supply when not in use, before fitting or removing parts and before cleaning.

Safety of others

- ◆ Do not allow children or any person unfamiliar with these instructions to use the appliance.

- ◆ Do not allow children or animals to come near the work area or to touch the appliance or power supply cord. Close supervision is necessary when the appliance is used near children.
- ◆ This appliance is not intended for use by persons (including children) with reduced physical, sensory or mental capabilities, or lack of experience and knowledge, unless they have been given supervision or instruction concerning use of the appliance by a person responsible for their safety.

After use

- ◆ Switch off and remove the plug from the socket before leaving the appliance unattended and before changing, cleaning or inspecting any parts of the appliance.
- ◆ When not in use, the appliance should be stored in a dry place. Children should not have access to stored appliances.

Inspection and repairs

- ◆ Before use, check the appliance for damaged or defective parts. Check for breakage of parts, damage to switches and any other conditions that may affect its operation.
- ◆ Do not use the appliance if any part is damaged or defective.
- ◆ Have any damaged or defective parts repaired or replaced by an authorised repair agent.
- ◆ Before use, check the power supply cord for signs of damage, ageing and wear.
- ◆ Do not use the appliance if the power supply cord or mains plug is damaged or defective.
- ◆ If the power supply cord or mains plug is damaged or defective it must be repaired by an authorised repair agent in order to avoid a hazard. Do not cut the power supply cord and do not attempt to repair it yourself.
- ◆ Never attempt to remove or replace any parts other than those specified in this manual.

Electrical safety



This tool is double insulated; therefore no earth wire is required. Always check that the power supply corresponds to the voltage on the rating plate.

- ◆ If the supply cord is damaged, it must be replaced by the manufacturer or an authorised Black & Decker Service Centre in order to avoid a hazard.

Additional safety instructions for vacuum cleaners

- ◆ Before use, always make sure that the filters are correctly seated. Do not use the appliance without all filters in place.
- ◆ Do not carry the appliance at the container handle.
- ◆ Do not use the appliance to pick up liquids.
- ◆ Do not use the appliance to pick up any materials that could catch fire.
- ◆ Do not use the appliance near water. Do not immerse the appliance in water.
- ◆ Keep the motor draught away from your eyes and face.
- ◆ Keep children and animals at a safe distance when using this appliance.
- ◆ Always work from bottom up when using the appliance on stairs, and keep the appliance at least a stair below your working position.
- ◆ Always be aware of the position of the power cord and hose while using the appliance.
- ◆ Do not use the appliance without the suction head or another suitable accessory mounted to the tube.
- ◆ After use, fully rewind the power cord and store the appliance in a tidy manner.
- ◆ Keep your hair, clothing and gloves away from moving parts.
- ◆ Do not use damaged accessories.
- ◆ Use only Black & Decker accessories.

Features

This appliance includes some or all of the following features:

1. On/off switch
2. Cord rewind button
3. Speed control selector
4. Handle
5. Hose
6. Airflow control switch
7. Extension tube
8. Suction head
9. Dust container
10. Wheels
11. Bin full indicator

In addition, this appliance is supplied with some or all of the following accessories (fig. A):

12. Crevice tool / Brush tool
13. Upholstery brush
14. Parquet floor head (VB2010P)

Assembly

Connecting the hose (fig. B)

- ◆ Insert the hose connector (15) into the inlet (16) of the appliance.
- ◆ Push the hose until the release buttons (17) click into place.
- ◆ To disconnect the hose, press the release buttons and pull out the hose.

Connecting the tube (fig. C)

- ◆ Push the hose nozzle (18) into the tube (7).
- ◆ To remove the tube, pull the hose out of the tube.

Mounting the suction head (fig. D)

The suction head (8) allows for vacuuming on carpet and hard surfaces (e.g. laminate and tiles).

- ◆ Push the tube (7) into the head (8).
- ◆ To remove the head, pull the tube out of the head.

VB2010P - Mounting the parquet floor head (fig. D)

The parquet floor head (14) allows for vacuuming on wooden and polished surfaces.

- ◆ Push the tube (7) into the head (14).
- ◆ To remove the head, pull the tube out of the head.

Mounting accessories (fig. D)

The crevice tool (12) allows for vacuuming in narrow and hard-to-reach places. The brush tool (12) allows for vacuuming on furniture, blinds, curtains, windows and stairs. The upholstery brush (13) allows for vacuuming furniture.

The accessories can be mounted on both the hose (5) and the tube (7).

- ◆ Push the accessory onto the hose nozzle (18) or the tube (7).
- ◆ To remove an accessory, pull the accessory from the hose nozzle or the tube.

Selecting the crevice tool or brush tool (fig. E)

- ◆ To use the crevice tool, move the brush part (19) against the direction of the arrow.
- ◆ To use the brush tool, move the brush part (19) in the direction of the arrow.

Use

Unwinding and rewinding the power cord

The cord rewind button (2) can be operated by hand or foot.

- ◆ Pull a sufficient length of cord from the back of the appliance.
- ◆ After use, press the cord rewind button to retract the cord into the unit. Manually guide the cord to ensure it does not swing back. Ensure the plug is correctly located.

Adjusting the tube length (fig. F)

The extension tube (7) can be adjusted as follows:

- ◆ Push the knob (20) and slide the tube to the desired length.
- ◆ Release the knob.

Adjusting the suction head (fig. D)

- ◆ For vacuuming on carpets, switch the brush actuator (21) into the up position.
- ◆ For vacuuming on laminates, tiles, etc., switch the brush actuator into the down position.

Switching on and off

The on/off switch (1) can be operated by hand or foot.

- ◆ To switch the appliance on, press the on/off switch (1).
- ◆ To switch the appliance off, press the on/off switch again.

Setting the suction force

The speed control selector (3) allows for a precise setting of the suction force.

For vacuuming on a hard surface (e.g. floors), choose a high speed setting. For vacuuming on soft surfaces (e.g. upholstery), choose a low speed setting.

- ◆ Slide the speed control selector to the desired setting.

Adjusting the airflow (fig. G)

Move the airflow control switch (6) to adjust the airflow as desired.

Vacuuming

- ◆ When operating the appliance, make sure that the hose is not trapped, twisted or blocked.
- ◆ In case of overheating, a cut-out will operate and the appliance will automatically stop.
- ◆ If the appliance stops operating, unplug the appliance and allow it to cool for 2-3 hours before continuing. Ensure the filters are cleaned and the unit is blockage free before switching back on.

Hints for optimum use

- ◆ When vacuuming stairs, always start at the bottom and work your way up. Position the appliance on the floor and do the stairs until halfway. Then carry the appliance to a stable position which is at least one stair below your working position, and do the top half of the stairs.

Carrying the appliance

During use the appliance can be carried using the handle (4).

Temporarily parking the suction head (fig. H)

- ◆ Use the park position (22) for a temporary parking of the suction head.

Storing the appliance (fig. I)

Warning! When storing the appliance, switch the appliance off and unplug it.

- ◆ Make sure that the cord is fully rewind.
- ◆ Place the appliance in an upright position.
- ◆ Park the tube in the park position (23).
- ◆ Store the appliance in a dry location.

Maintenance

Your Black & Decker appliance has been designed to operate over a long period of time with a minimum of maintenance. Continuous satisfactory operation depends upon proper appliance care and regular cleaning.

Warning! Before performing any maintenance or cleaning on the appliance, unplug the appliance.

- ◆ Regularly clean the ventilation slots in your appliance using a soft brush or dry cloth.
- ◆ Regularly clean the motor housing using a damp cloth. Do not use any abrasive or solvent-based cleaner.

Emptying the dust container (fig. J & K)

The dust container (9) must be emptied when the maximum mark is reached or the bin full indicator (11) changes from green to red.

- ◆ Remove the hose.
- ◆ Press the release button (24).
- ◆ Hold the dust container at the handle (25). Slide the container (9) out of the appliance.
- ◆ Hold the container over a waste bin.
- ◆ Press the release button (26) to open the container (fig. K). Empty the dust container as necessary.
- ◆ Close the base (27) by moving it upward until the lock locates in the latch.

- ◆ Re-insert the container into the appliance until it locks into place.

Cleaning (fig. J - N)

Warning! Before cleaning and maintenance, switch the appliance off and unplug it.

- ◆ From time to time wipe the appliance with a damp cloth. Do not use any abrasive or solvent-based cleaner.

Do not immerse the appliance in water.

The appliance is fitted with 5 filters.

Four of these are accessible to the user and are replaceable. The fifth filter is internal to protect the motor. The four filters are: pre-filter cover, main filter, bin filter and exhaust filter.

Cleaning the dust container filter (fig. J - M)

The dust container filter prevents dust and dirt from entering the motor housing. The filter is re-usable. There are two levels of filtration: pre-filter and main filter. To maintain efficient suction performance, the filter should be cleaned every week, or whenever suction performance is noticeably reduced. The appliance is fitted with a bypass valve. When the filter is clogged, the operation of the valve is audible. This is normal and does not indicate a problem. Switch off the appliance and remove the plug from the socket before cleaning the filters.

- ◆ Remove the container (9) from the appliance (fig. J).
- ◆ Empty the container (fig. K).
- ◆ Remove the cartridge (28) from the container by turning it clockwise (fig. L).
- ◆ Remove the pre-filter cover (29) from the main filter (30).
- ◆ Shake off excess dust by tapping the filter into a dustbin.

Warning! Do not brush or use compressed air to clean the filter.

- ◆ Depending on its condition, rinse the outside of the filter with water. Allow the filter to dry for 24 hours before re-inserting it.

Warning! Do not wash the inside of the filter.

- ◆ Take out the filter (31) located right below the grid and brush off any loose dust before re-inserting it.
- ◆ Slide the pre-filter cover back over the main filter.
- ◆ Place the cartridge back in the container by turning it counterclockwise.
- ◆ Close the container.
- ◆ Re-insert the dust container into the appliance.

Cleaning the exhaust filter (fig. N)

The exhaust filter gives a further filtration level. The filter is re-usable and should be cleaned regularly.

- ◆ Remove the lid (32).
- ◆ Take the exhaust filter (33) out.
- ◆ Brush any loose dust off the filter.
- ◆ Re-insert the filter.
- ◆ Close the lid.

Replacing the filters (fig. J - N)

The container filter should be replaced every 6 to 9 months and whenever worn or damaged. When replacing the dust container filter, the pre-filter, main motor filter and the exhaust filters have to be replaced as well. Replacement filter sets (all 4 filters - VBF60-OX) are available from your Black & Decker dealer.

Replacing the pre-filter and main container filter (fig. J - M)

- ◆ Proceed as described above to replace the filters.

Replacing the exhaust filter (fig. N)

- ◆ Proceed as described above to replace the filter.

Mains plug replacement (U.K. & Ireland only)

If a new mains plug needs to be fitted:

- ◆ Safely dispose of the old plug.
- ◆ Connect the brown lead to the live terminal in the new plug.
- ◆ Connect the blue lead to the neutral terminal.

Warning! No connection is to be made to the earth terminal. Follow the fitting instructions supplied with good quality plugs. Recommended fuse: 13 A.

Protecting the environment



Separate collection. This product must not be disposed of with normal household waste.

Should you find one day that your Black & Decker product needs replacement, or if it is of no further use to you, do not dispose of it with household waste. Make this product available for separate collection.



Separate collection of used products and packaging allows materials to be recycled and used again. Re-use of recycled materials helps prevent environmental pollution and reduces the demand for raw materials.

Local regulations may provide for separate collection of electrical products from the household, at municipal waste sites or by the retailer when you purchase a new product.

Black & Decker provides a facility for the collection and recycling of Black & Decker products once they have reached the end of their working life. To take advantage of this service please return your product to any authorised repair agent who will collect them on our behalf.

You can check the location of your nearest authorised repair agent by contacting your local Black & Decker office at the address indicated in this manual. Alternatively, a list of authorised Black & Decker repair agents and full details of our after-sales service and contacts are available on the Internet at: **www.2helpU.com**

Technical data

		VB2000	VB2010P
Voltage	V	230	230
Power input	W	2,000	2,000
Cable length	m	5	5
Container size	l	2.5	2.5
Weight	kg	6.0	6.2

EC declaration of conformity

VB2000/VB2010P TYPE1

Black & Decker declares that these products conform to:

89/336/EEC, 73/23/EEC, EN 55014, EN 61000, EN 60335

Level of sound pressure, measured according to EN 60704-1: 71 dB(A)

The undersigned is responsible for compilation of the technical file and makes this declaration on behalf of Black & Decker.



Kevin Hewitt

Director of Consumer Engineering
Spennymoor, County Durham DL16 6JG,
United Kingdom
30-4-2009

- ◆ The product has been used for trade, professional or hire purposes;
- ◆ The product has been subjected to misuse or neglect;
- ◆ The product has sustained damage through foreign objects, substances or accidents;
- ◆ Repairs have been attempted by persons other than authorised repair agents or Black & Decker service staff.

To claim on the guarantee, you will need to submit proof of purchase to the seller or an authorised repair agent. You can check the location of your nearest authorised repair agent by contacting your local Black & Decker office at the address indicated in this manual.

Alternatively, a list of authorised Black & Decker repair agents and full details of our after-sales service and contacts are available on the Internet at: **www.2helpU.com**

Please visit our website **www.blackanddecker.co.uk** to register your new Black & Decker product and to be kept up to date on new products and special offers. Further information on the Black & Decker brand and our range of products is available at **www.blackanddecker.co.uk**

Guarantee

Black & Decker is confident of the quality of its products and offers an outstanding guarantee. This guarantee statement is in addition to and in no way prejudices your statutory rights. The guarantee is valid within the territories of the Member States of the European Union and the European Free Trade Area.

If a Black & Decker product becomes defective due to faulty materials, workmanship or lack of conformity, within 24 months from the date of purchase, Black & Decker guarantees to replace defective parts, repair products subjected to fair wear and tear or replace such products to ensure minimum inconvenience to the customer unless:

Partial support - Only parts shown available
 Nur die aufgeführten teile sind lieferbar
 Réparation partielle - Seules les pièces indiquées sont disponibles
 Supporto parziale - Sono disponibili soltanto le parti evidenziate
 Solo estan disponibles las piezas listadas
 So se encontram disponíveis as peças listadas
 Gedeeltelijke ondersteuning - alleen de getoonde onderdelen
 zijn beschikbaar

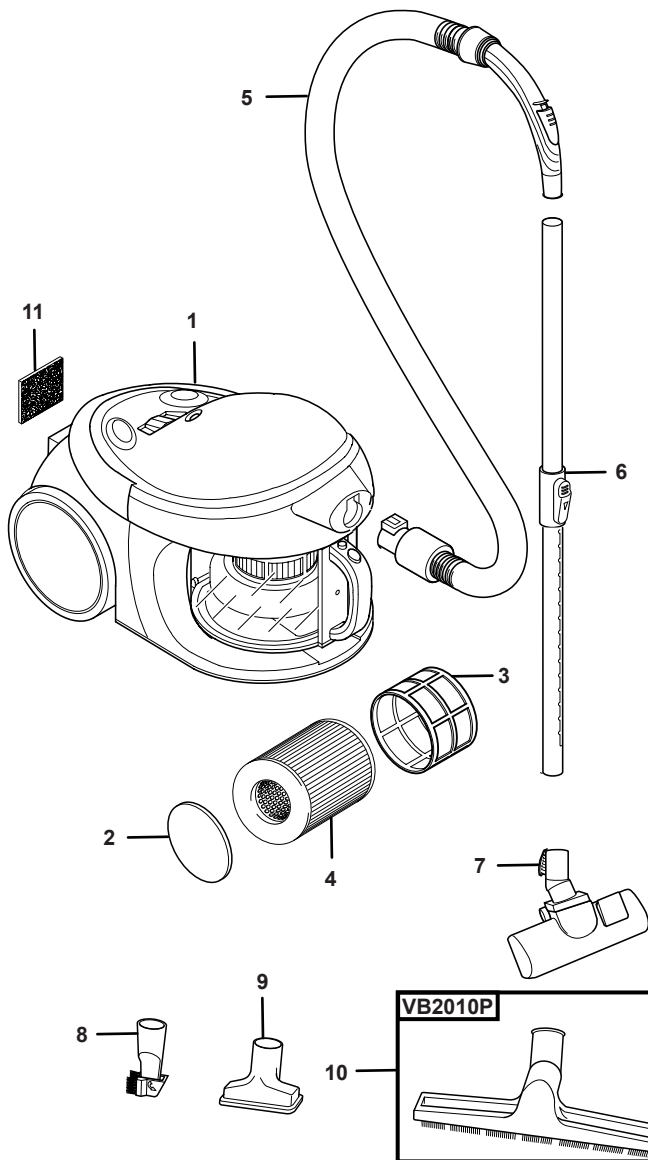

ENGLISH

Do not forget to register your product!

www.blackanddecker.co.uk/productregistration

Register your product online at **www.blackanddecker.co.uk/productregistration** or
send your name, surname and product code to Black & Decker in your country.

Australia	Black & Decker (Australia) Pty. Ltd. 20 Fletcher Road, Mooroolbark, Victoria, 3138	Tel.	03-8720 5100
		Fax	03-9727 594065
New Zealand	Black & Decker 5 Te Apunga Place Mt Wellington Auckland 1060	Tel.	+64 9 259 1133
		Fax	+64 9 259 1122
United Kingdom	Black & Decker 210 Bath Road Slough, Berkshire SL1 3YD	Tel.	01753 511234
		Fax	01753 551155
		Helpline	01753 574277