

www.blackanddecker.com.au
www.blackanddecker.co.nz

BHFE520J
BHFE620J

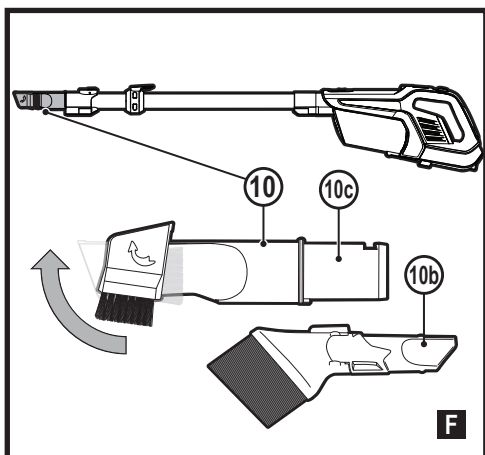

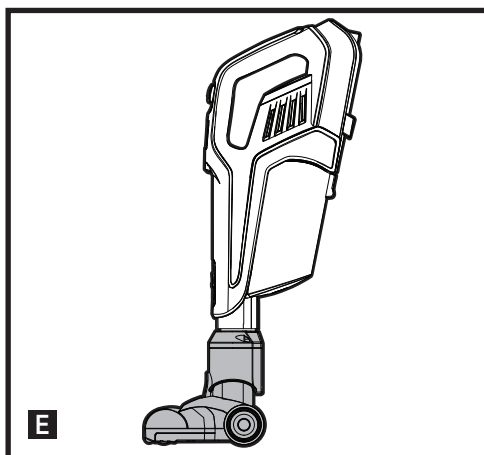

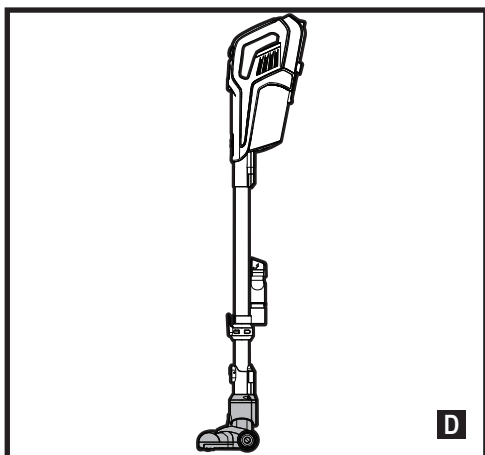
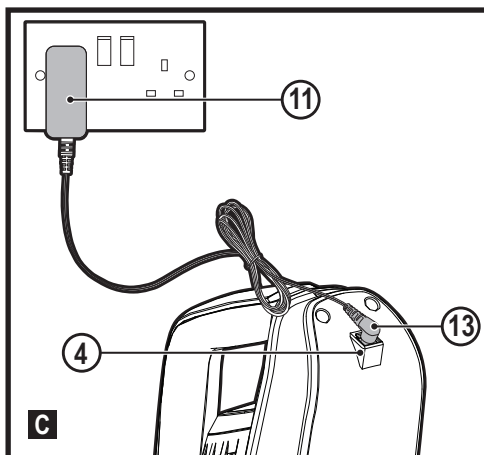
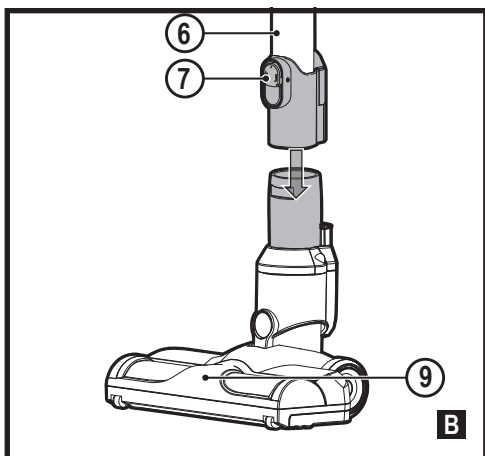
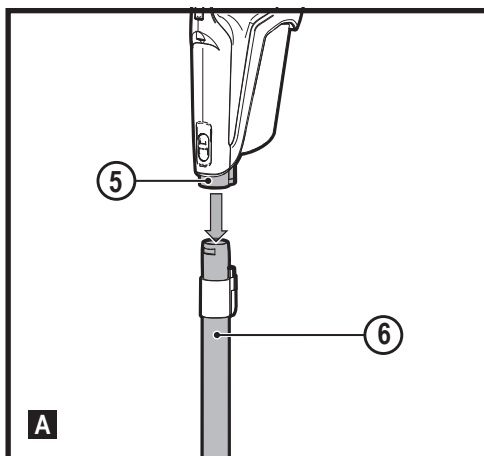
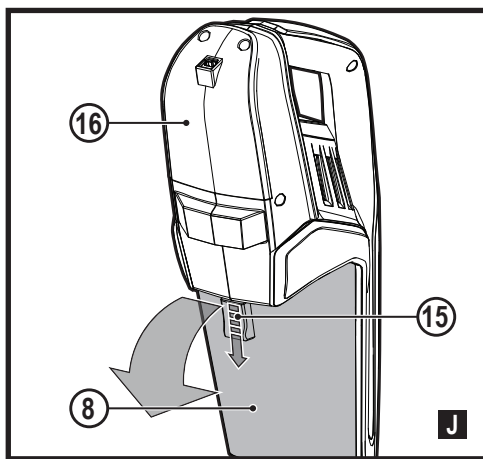
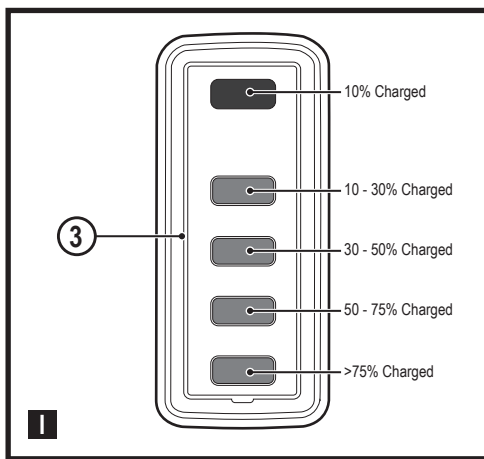
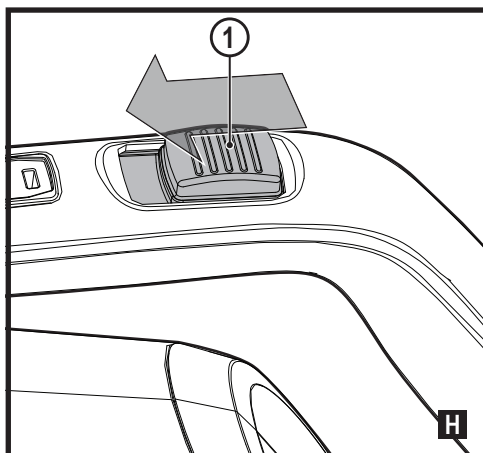
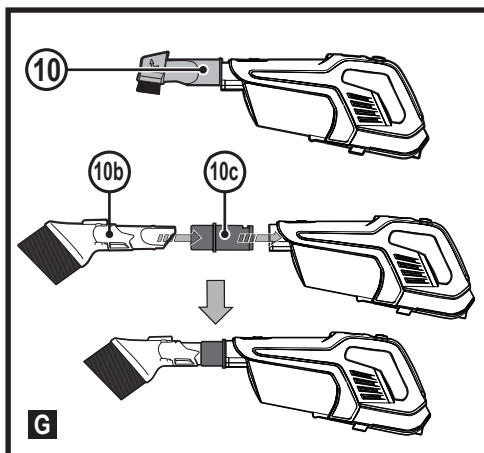
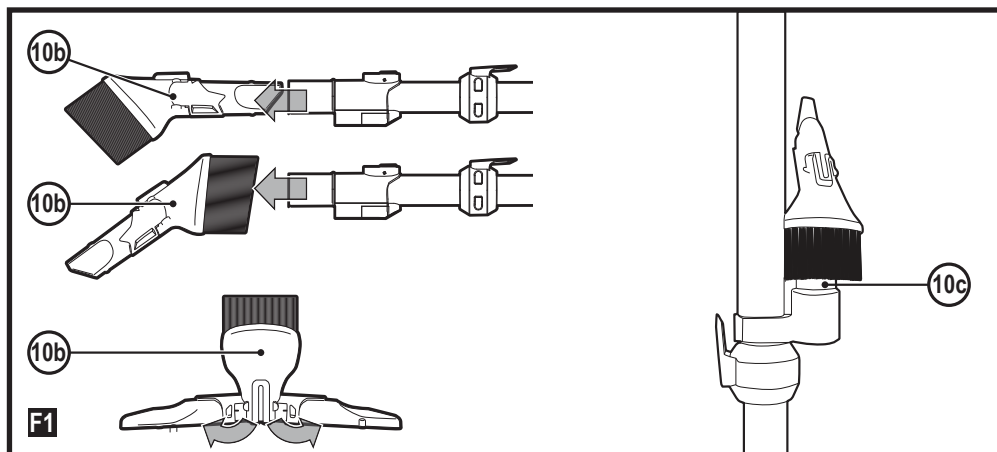
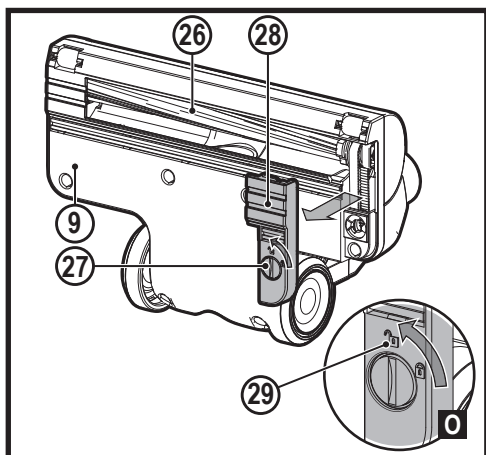
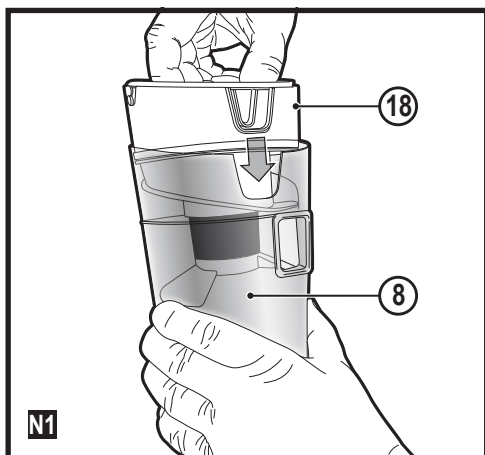
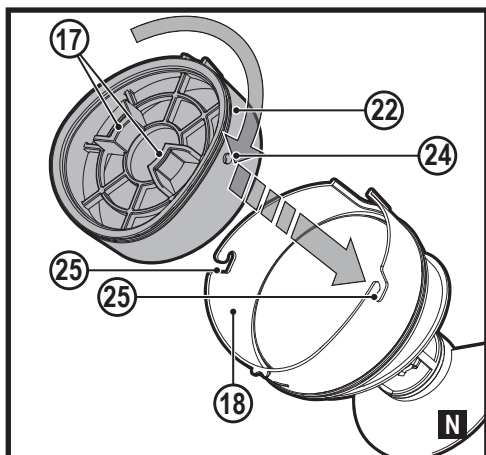
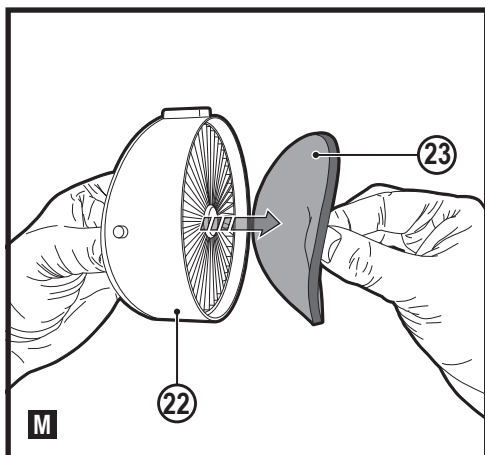
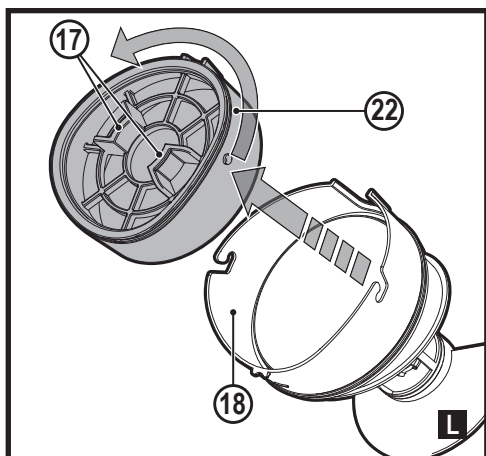
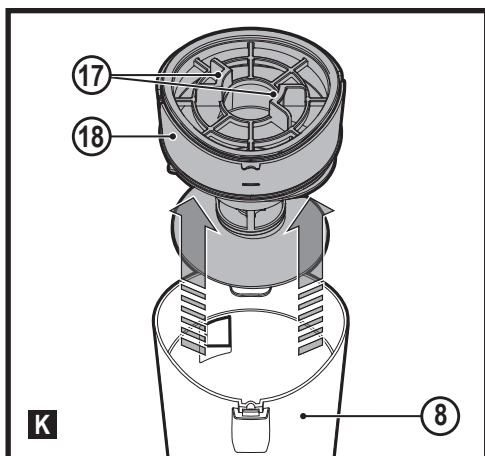

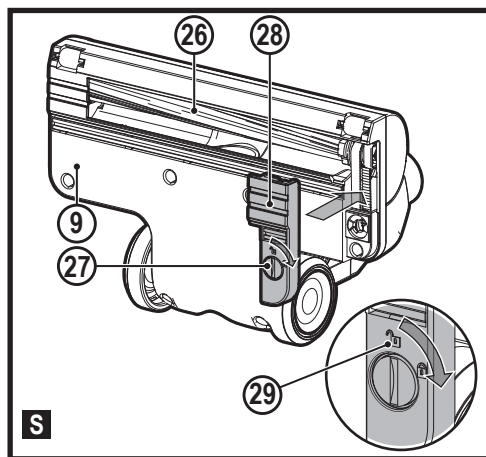
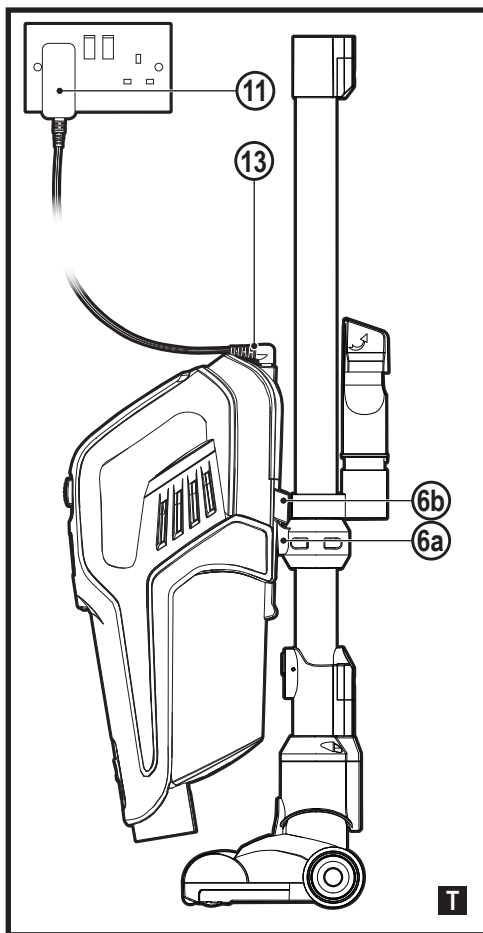
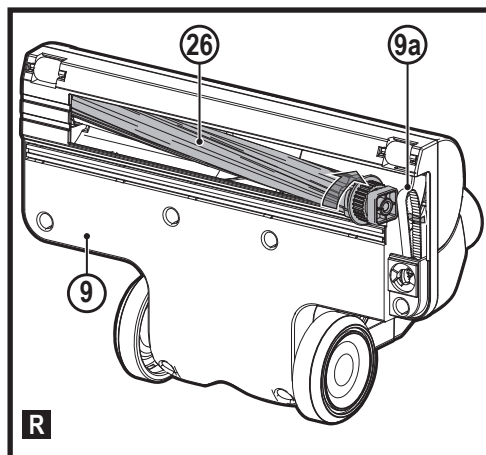
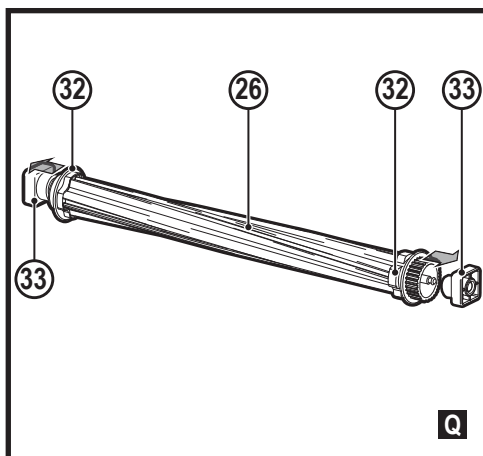
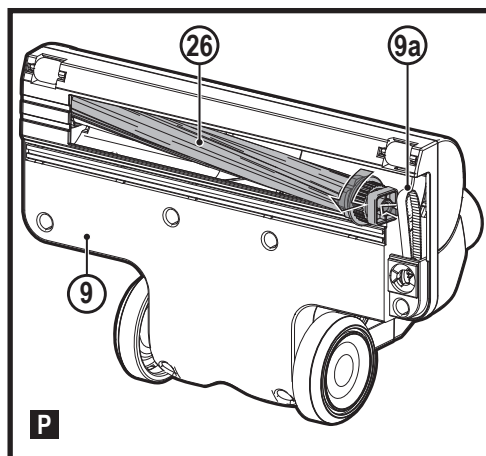

Intended use

Your BLACK+DECKER BHFE520J and BHFE620J 3 in 1 cordless vacuum cleaners have been designed for vacuum cleaning purposes. These appliances are intended for household use only.



Read all of this manual carefully before operating the appliance.

Safety instructions**Warning! Read all safety warnings and all instructions.**

Failure to follow the warnings and instructions listed below may result in electric shock, fire and/or serious injury.

- ♦ The intended use is described in this manual. The use of any accessory or attachment or the performance of any operation with this appliance other than those recommended in this instruction manual may present a risk of personal injury.
- ♦ Retain this manual for future reference.

Using your appliance

- ♦ Do not use the appliance to pick up liquids or any materials that could catch fire.
- ♦ Do not use the appliance near water.
- ♦ Do not immerse the appliance in water.
- ♦ Never pull the charger lead to disconnect the charger from the socket. Keep the charger lead away from heat, oil and sharp edges.
- ♦ This appliance can be used by

children aged from 8 years and above and persons with reduced physical, sensory or mental capabilities or lack of experience and knowledge if they have been given supervision or instruction concerning use of the appliance in a safe way and understand the hazards involved. Children shall not play with the appliance. Cleaning and user maintenance shall not be made by children without supervision.

Inspection and repairs

Before use, check the appliance for damaged or defective parts. Check for breakage of parts, damage to switches and any other conditions that may affect its operation.

- ♦ Do not use the appliance if any part is damaged or defective.
- ♦ Have any damaged or defective parts repaired or replaced by an authorized repair agent.
- ♦ Regularly check the charger lead for damage. Replace the charger if the lead is damaged or defective.
- ♦ Never attempt to remove or replace any parts other than those specified in this manual.

Additional safety instructions**After use**

- ♦ Unplug the charger before cleaning the charger or charging base.
- ♦ When not in use, the appliance should be stored in a dry place.

- ♦ Children should not have access to stored appliances.

Residual risks

Additional residual risks may arise when using the tool which may not be included in the enclosed safety warnings. These risks can arise from misuse, prolonged use etc.

Even with the application of the relevant safety regulations and the implementation of safety devices, certain residual risks can not be avoided. These include:

- ♦ Injuries caused by touching any rotating/moving parts.
- ♦ Injuries caused when changing any parts, blades or accessories.
- ♦ Injuries caused by prolonged use of a tool. When using any tool for prolonged periods ensure you take regular breaks.
- ♦ Impairment of hearing.
- ♦ Health hazards caused by breathing dust developed when using your tool (example:- working with wood, especially oak, beech and MDF.)

Chargers

Your charger has been designed for a specific voltage. Always check that the mains voltage corresponds to the voltage on the rating plate.

Warning! Never attempt to replace the charger unit with a regular mains plug.

- ♦ Use your BLACK+DECKER charger only to charge the battery in the appliance with which it was supplied. Other batteries could burst, causing

personal injury and damage.

- ♦ Never attempt to charge non-rechargeable batteries.
- ♦ If the supply cord is damaged, it must be replaced by the manufacturer or an authorised BLACK+DECKER Service Centre in order to avoid a hazard.
- ♦ Do not expose the charger to water.
- ♦ Do not open the charger.
- ♦ Do not probe the charger.
- ♦ The appliance/battery must be placed in a well ventilated area when charging.

Electrical safety

Symbols on the charger



Read all of this manual carefully before using the appliance.



This tool is double insulated; therefore no earth wire is required. Always check that the power supply corresponds to the voltage on the rating plate.



The charging base is intended for indoor use only.

Labels on appliance

The following symbols appear on this appliance along with the date code



Read all of this manual carefully before using the appliance



BHFE520J use charger S010QU2300040

BHFE620J use charger S014CU270050

Features

This tool includes some or all of the following features.

1. On/off power switch
2. Main handle
3. State of charge indicator
4. Charging port
5. Vacuum inlet
6. Extension tube
7. Accessory release latch
8. Dust canister

- 9. Floor head
- 10. 2 in 1 Accessory tool (BHFE520J only)
- 10a. Accessory storage clip
- 10b. 3 in 1 accessory tool (BHFE620J only)
- 10c. 3 in 1 accessory tool adapter
- 11. Jack plug charger
- 12. LED worklight

Assembly (Fig. A, BF)

- ◆ Align the top of the extension tube (6) with the vacuum inlet (5) as shown in Fig. A.
- ◆ Push the extension tube (6) onto the vacuum inlet (5) so it locks into position.
- ◆ Align the bottom of the extension tube (6) with the floor head (9) as shown in Fig. B.
- ◆ Push the bottom of the extension tube (6) onto the floor head (9) so it locks into position.
- ◆ To remove an accessory, press the accessory release latch (7) located on the vacuum or extension tube and gently pull the connected accessory off.

Warning! When not in use position the unit with the rear of the vacuum facing a wall so that any inadvertent fall of the unit would contact a wall and not people or pets.

Charging the battery (Fig. C)

Warning! Use only with the supplied charger.

From new, the rechargeable cells of the product need a minimum charge time of 5 hours to ensure full power.

Note: We recommend that you charge the unit in the storage position as shown in figure T.

- ◆ The unit must be turned Off in order to charge.
- ◆ Fig. C - Plug the jack plug (13) of the jack plug charger (11) into the charging port (4) of the vacuum.
- ◆ Plug the charger into a standard electrical outlet.
- ◆ While charging, the charger may get warm, this is perfectly normal and safe. It is safe to leave the appliance connected to the charger indefinitely. The charger automatically reduces power consumption when charging is complete.

Warning! Do not charge the battery at ambient temperatures below 4 °C or above 40 °C. Follow all charging instructions and do not charge the appliance outside of the temperature range specified in the instructions. Charging improperly or at temperatures outside of the specified range may damage the battery and increase risk of fire.

State of charge indicator

This appliance includes a state of charge indicator (3) which consists of three green and one red LED lights that indicate the level of charge remaining in the battery. This feature is only activated when the vacuum is powered on.

The state of charge indicator is an indication of approximate

levels of charge remaining in the battery pack.

The LED battery indicator displays the remaining charge and warns you when the battery is low. The final red LED will flash continuously when there is only very little runtime remaining.

Note: The state of charge indicator is only an indication of the charge left on the battery. It does not indicate tool functionality and is subject to variation based on product components, temperature and end-user application.

Use

This vacuum cleaner can be used in one of four ways.

- ◆ With the extension tube (6) and the floor head (9) as shown in figure D.
- ◆ With the floor brush (9) and the vacuum as shown in figure E.
- ◆ With the extension tube (6) and the 2 in 1 Accessory tool (10) as shown in figure F.
- ◆ With the 2-in-1 accessory tool (10) and the 3-in-1 accessory tool (10b), and the vacuum as shown in figure G.

Note: The 2-in-1 accessory tool (10) can be used either as a crevice tool or a brush tool, as shown in figure F. The 3-in-1 accessory tool (10b) can be used as a crevice tool, as brush tool and an upholstery tool, as shown in figure F1.

Using the 3-in-1 accessory tool (Fig F1)

- ◆ The 3-in-1 accessory tool (10b) has three configurations:
 1. Brush mode
 2. Small crevice mode
 3. Upholstery mode
- ◆ The 3-in-1 accessory tool can be fitted either directly to the extension pole (Fig F), or the to the hand-held unit (Fig G) by means of the adapter provided (10c)

Switching ON and OFF (Fig. H)

- ◆ To switch ON, slide the on/off power switch (1) forward to the "I" position.
- ◆ For increased power, slide the On/Off switch (1) forward to the "II" position.

Note: The floor head (9) will power on when it is attached to the vacuum or extension tube. The LED worklight (12) will illuminate whenever the unit is switched ON.

Note: The state of charge indicator LEDs (3) will illuminate while the vacuum is ON as shown in figure I.

- ◆ To switch OFF, slide the on/off power switch (1) to the "O" position.
- ◆ Return the product to the charger immediately after use so that it will be ready and fully charged for the next use. Ensure that the product is fully engaged with the charger plug.

Cleaning and emptying the vacuum

Warning! Projectile/Respiratory Hazard: Never use the vac without its filter.

Warning! The filter is re-usable, do not confuse it with a disposable dust bag, and do not throw it away when the product is emptied. We recommend that you replace the filter every 6–9 months depending on frequency of use. There are two methods of cleaning the canister, a quick empty method and a thorough clean method.

To empty the dust canister (Fig. J, K)

- ◆ Push down the dust canister release button (15) to release and remove the dust canister (8) from the vacuum (16) as shown in figure J.
- ◆ Use your index finger and thumb to pinch the filter housing tabs (17) and pull the filter housing (18) from the dust canister as shown in Fig. K.
- ◆ Place the dust canister over a trash can and empty the dust canister.
- ◆ Install the filter housing into the dust canister (8) ensuring the dust canister slots align with the filter housing tabs as shown in figure N1.
- ◆ Install the dust canister onto the vacuum, until it “clicks” firmly into position.

Note: Ensure the dust port is placed towards the main handle of the vacuum and the dust canister release button (15) is facing away from the vacuum (16).

Cleaning the filters (Fig. L, M, N)

Note: Maximum dust collection will only be obtained with clean filters and an empty dust canister. If dust begins to fall back out of the product after it is switched off, this indicates that the dust canister is full and requires emptying.

- ◆ Wash the filters regularly using warm, soapy water and ensure that they are completely dry before using again. The cleaner the filter is, the better the product will perform.
- ◆ It is very important that the filters are correctly in position before use.
- ◆ Pull back on the dust canister release button (15) to release and remove the dust canister (8) from the vacuum (16) as shown in figure J.
- ◆ Use your index finger and thumb to pinch the filter tabs (17) and lift the filter housing (18) from the dust canister as shown in figure K.
- ◆ Once the filter housing is removed from the dust canister, use your index finger and thumb to pinch the filter tabs (17) and rotate the filter (22) anti-clockwise and remove it as shown in figure L.
- ◆ Remove the foam filter (23) from the filter housing as shown in figure M.
- ◆ Shake or lightly brush any loose dust off of the foam filter (23) and filter (22).

- ◆ Rinse out the dust canister (8) with warm soapy water.
- ◆ Wash the filters with warm soapy water.
- ◆ Ensure the filters are completely dry before refitting the filters into the filter housing (18).
- ◆ Refit the clean and dry foam filter (23) into the filter housing (18).
- ◆ Refit the clean and dry filter (23) into the filter (22) by aligning the filter locks (24), located on the sides of the filter, with the filter housing slots (25), located on the sides of the filter housing, and turn the filter clockwise until it locks firmly into position as shown in figure N.
- ◆ Install the filter housing into the dust canister (8) ensuring the dust canister slots align with the filter housing tabs as shown in figure N1.
- ◆ Install the dust canister onto the vacuum, until it “clicks” firmly into position.

Note: Ensure the dust port is placed towards the main handle (2) of the vacuum and the dust canister release button (15) is facing away from the vacuum (16).

Removing and cleaning the rotary brushes (Fig. O, P, Q, R, S)

Warning! To reduce the risk of injury from moving parts, disconnect the floor brush from the vacuum before cleaning or servicing.

- ◆ To remove the rotary brush (26) from the floor head (9) use a coin or straight screwdriver to rotate the lock (27) on the lock plate (28) to the unlocked position (29) as shown in figure O.
- ◆ Remove the lock plate (28).
- ◆ Ease the drive belt (9a) away from the rotary brush (26)
- ◆ The rotary brush (26) can now be removed.

Note: The bearings (33) are also removable from the end pieces (32) allowing you to clear the brushes of any hair or other debris that may have accumulated as shown in figure Q.

- ◆ Once the rotary brush has been cleaned, reinstall the rotary brush into the floor head (9) as shown in figure R.
- ◆ Install the lock plate (28) onto the floor head (9) as shown in figure S.
- ◆ Use a coin or straight screwdriver to rotate the lock (27) on the lock plate (28) to the locked position (36) as shown in figure S.

Safe storage (Fig. T)

The unit can be safely stored, when not in use, by placing the catch on the motor unit (6b) onto the storage hook (6a) as shown in figure T.

Maintenance

Your BLACK+DECKER cordless appliance has been designed to operate over a long period of time with a minimum of maintenance. Continuous satisfactory operation depends upon proper tool care and regular cleaning.

Warning! Before performing any maintenance on cordless appliances:

- ◆ Run the battery down completely if it is integral and then switch off.
- ◆ Unplug the charger before cleaning it. Your charger does not require any maintenance apart from regular cleaning.
- ◆ Regularly clean the ventilation slots in your appliance/charger using a soft brush or dry cloth.
- ◆ Regularly clean the motor housing using a damp cloth. Do not use any abrasive or solvent-based cleaner.

Replacing the filters

The filters should be replaced every 6 to 9 months and whenever worn or damaged. Replacement filters are available from your BLACK+DECKER dealer.

- ◆ Remove the old filters as described above.
- ◆ Fit the new filters as described above.

Protecting the environment



Separate collection. Products and batteries marked with this symbol must not be disposed of with normal household waste.

Products and batteries contain materials that can be recovered or recycled reducing the demand for raw materials.

Please recycle electrical products and batteries according to local provisions. Further information is available at www.2helpU.com

Technical Data

	BHFE520J	BHFE620J
Voltage	18V	21.6V
Watt Hours	36Wh	43.2Wh
Weight	2.02Kg	2.06Kg

Australia & New Zealand

Stanley Black & Decker

www.blackanddecker.com.au

www.blackanddecker.co.nz

Tel. 1800 338 002 (Aust) or Tel. 0800 339 258 (NZ)